

# RTM Engineering Product

29 June 2020

# Bucket Elevator





# Wilmar new demand

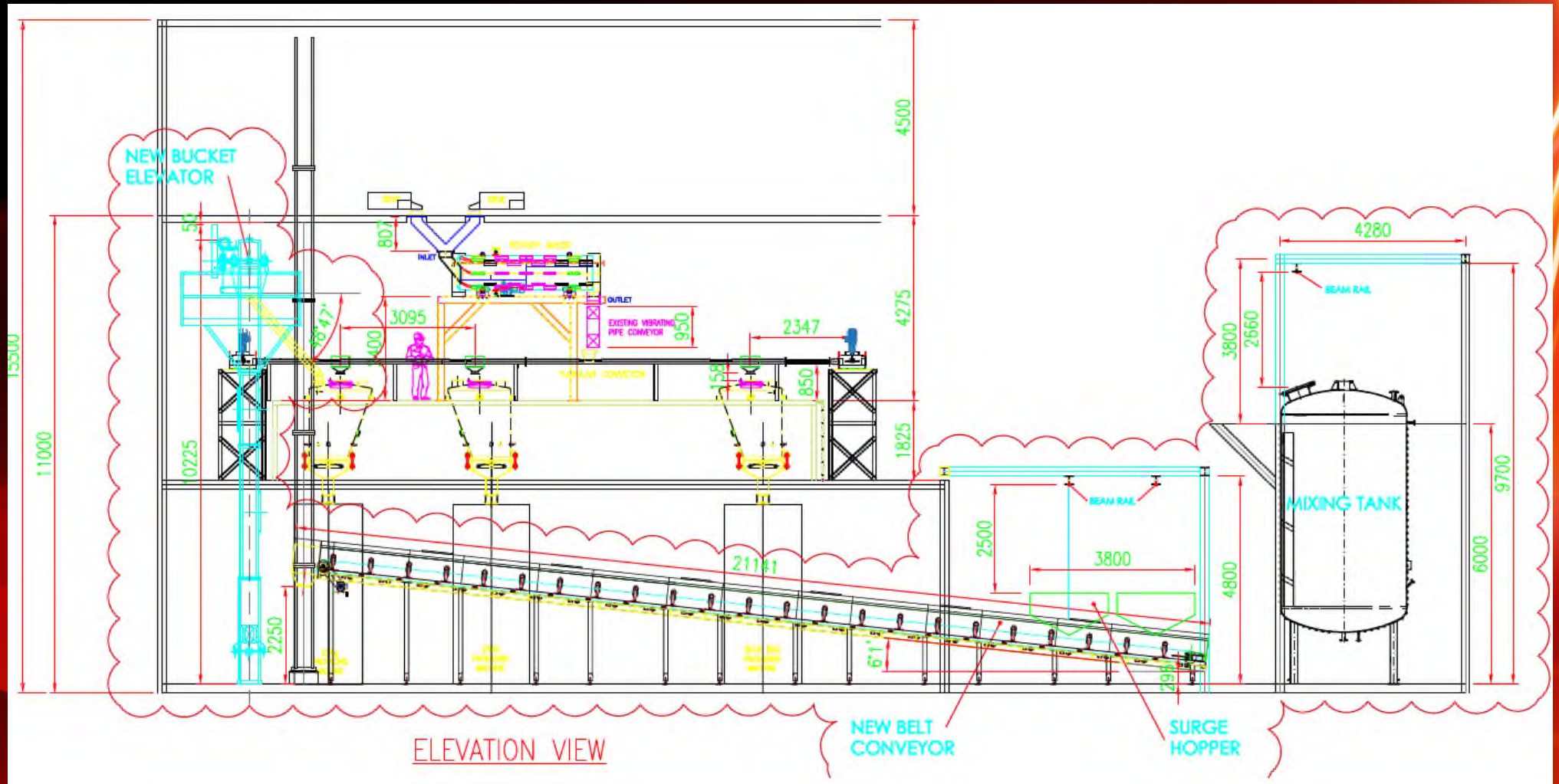

# Sourcing from China





# Tensioning Design, Split Sprocket Design



# Drive unit use Fenner replace Dodge

Fenner SMSR equivalent to Dodge 903000



SHAFT MOUNTED DESIGN





# Explosion Vent Panel



## Explosion Vent Panels



**ATEX APPROVED**  
Ex II GD Ta - 15 to +60°C

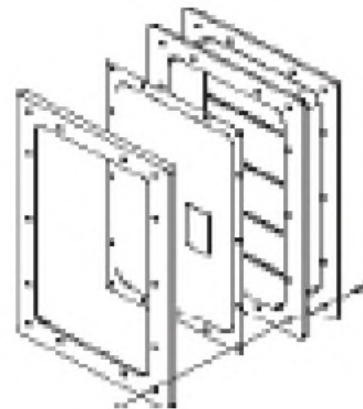

**BRP Flat Panels**

### APPLICATION

The 4B Explosion Vent Panels open quickly at a

# Explosion Vent Panel





# Roller Tyre





## GRINDING CONCEPTS IN VERTICAL ROLLER MILL



**Ranteindo**  
Engineering. Surveying. Solutions.



LOESCHE MILL  
LM56 3+3

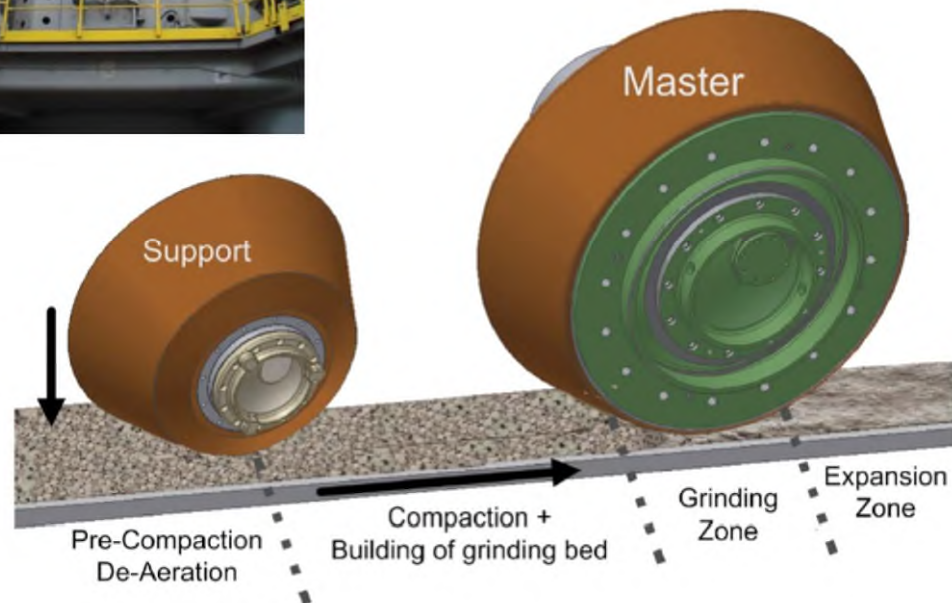

Mill Animation Flow during  
it's operational

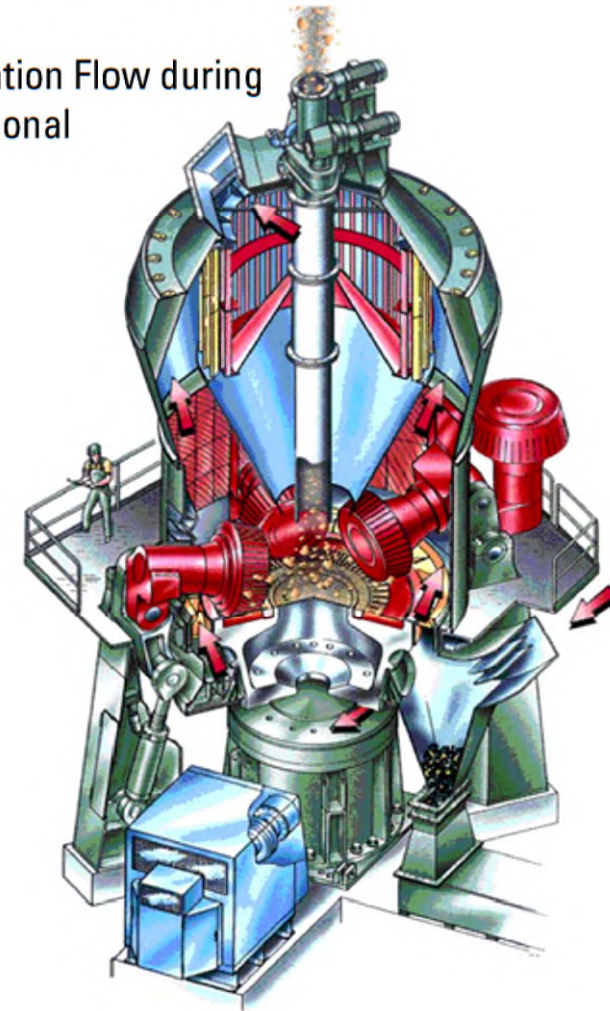



# Measurement of Roller Tyre



## 检查报告

公司: 唐山卓文重型齿轮  
 操作员: 李洪刚  
 日期: 2020年5月12日 星期二  
 时间: 下午 1:04:35  
 工件温度: 20.0C

特征	坐标	偏差	公差	公差	公差
TCAG2 计算元素 = CON1					
圆锥	57.0000	57.0486	0.0486	0.0000	0.0000
					好
TDM1 计算元素 = CYL1					
圆柱	1630.0000	1630.6664	0.6664	0.0000	0.0000
					好
FM82 计算元素 = CYL2					
圆柱	1580.0000	1580.6046	0.6046	0.0000	0.0000
					好

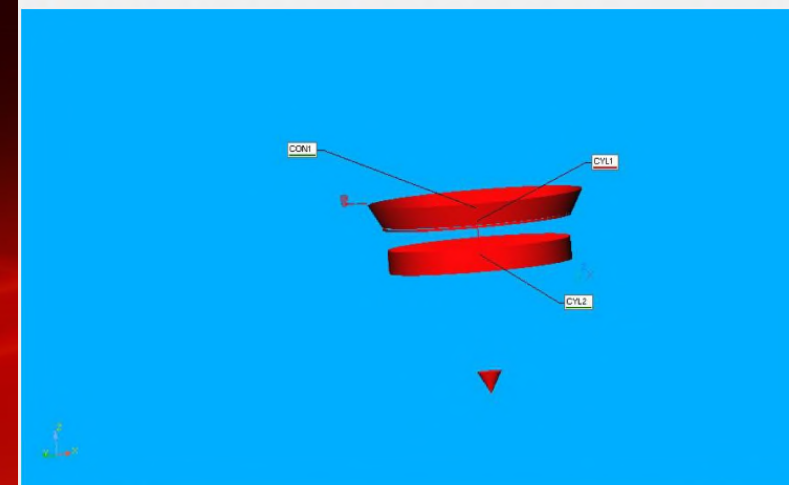

TCAG3 计算元素 = CON2					
圆锥	30.0248	30.0248	0.0000	-0.3000	0.3000
					好
TCAG4 计算元素 = CON3					
圆锥	30.0583	30.0583	0.0000	-0.3000	0.3000
					好

# Head & Drum Shaft

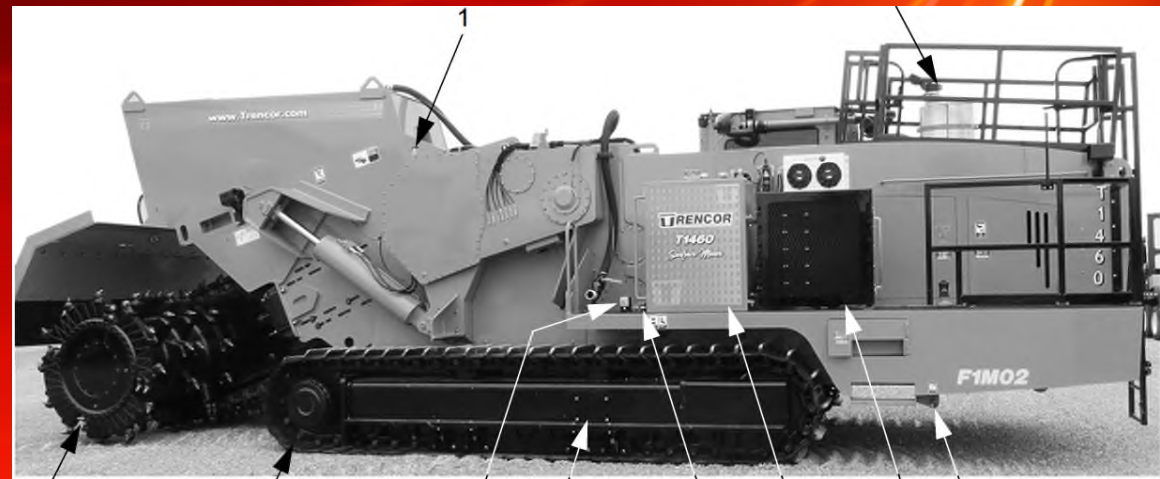



# Head & Drum shaft application

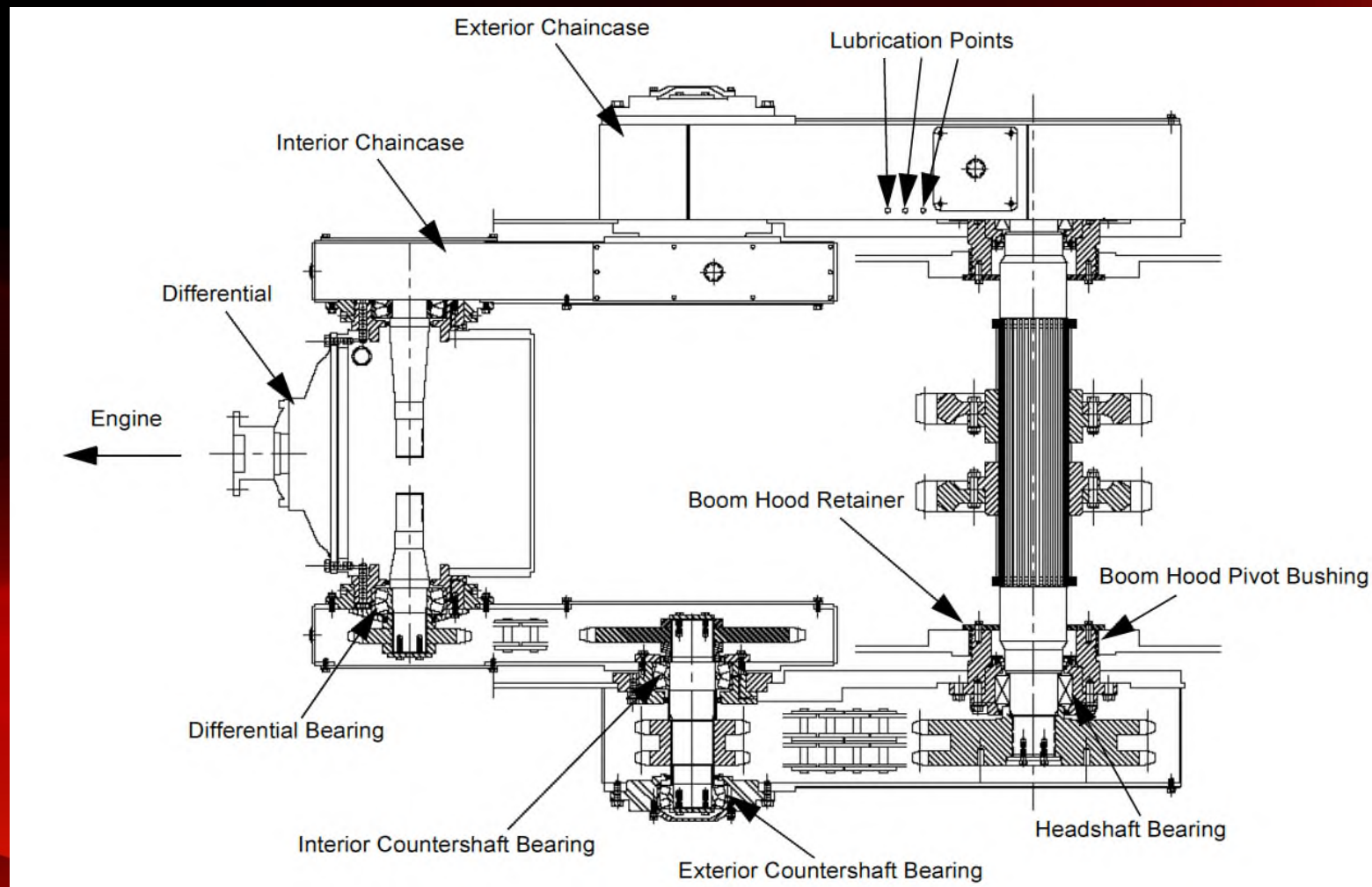

# PINION Gear





# Progress in China

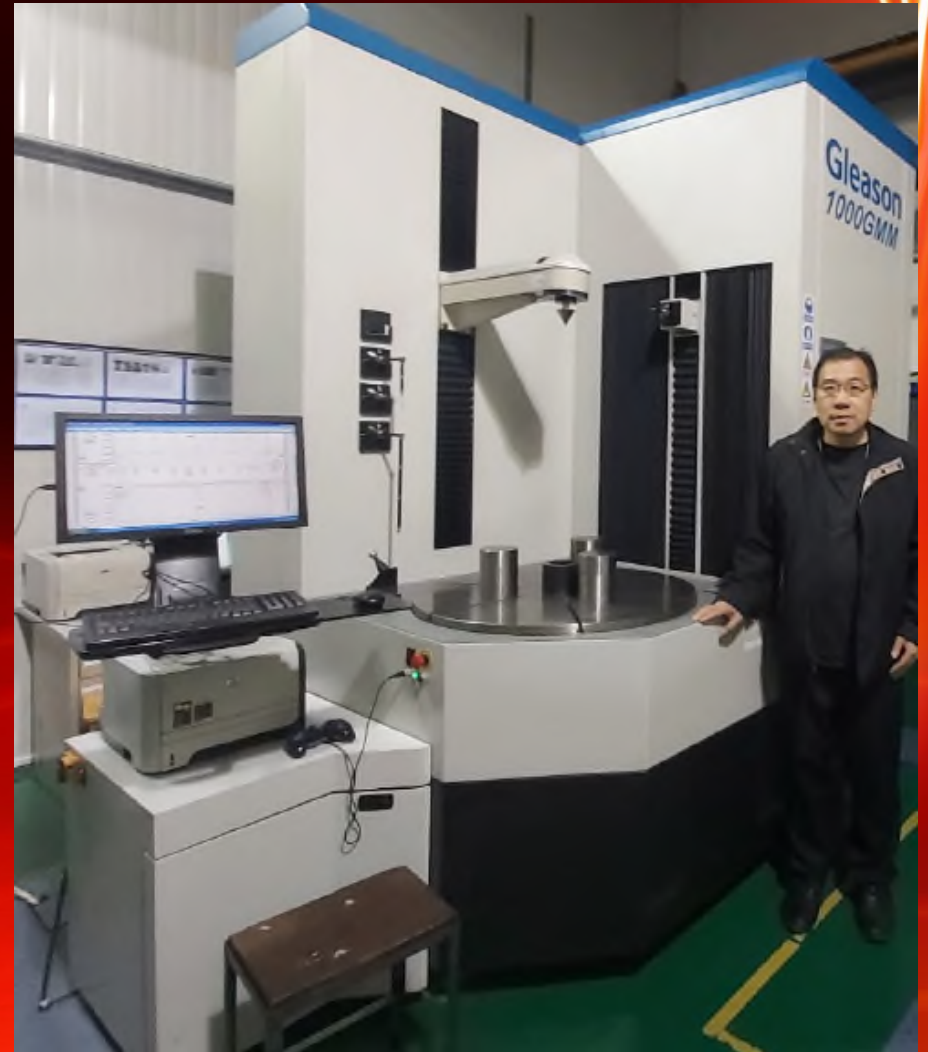
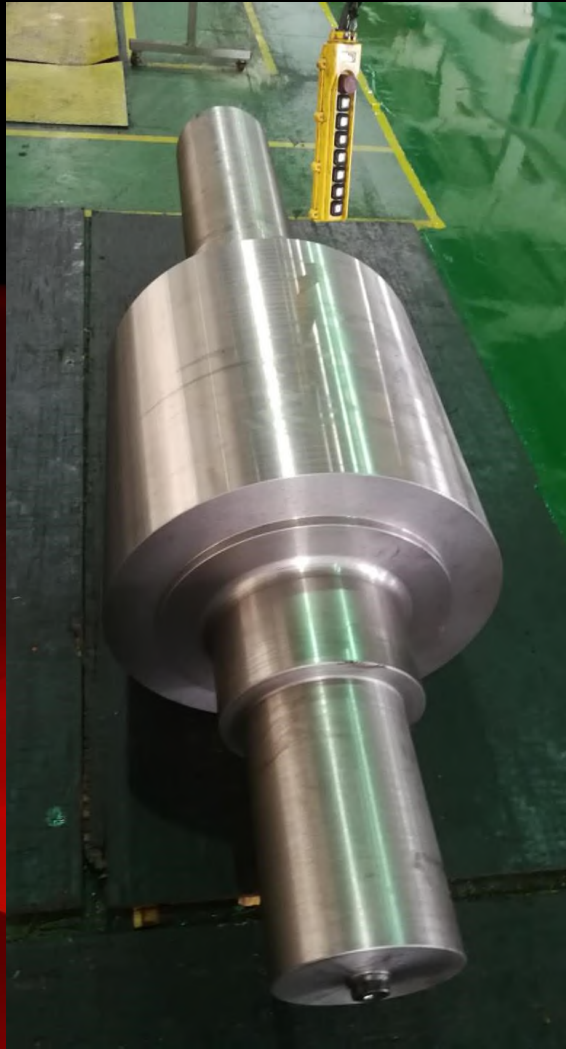

# Gear Grinding Equipment in China





# Drop Forge Chain

**chain flights & configurations**





# Pitch 304.8mm Forge Chain

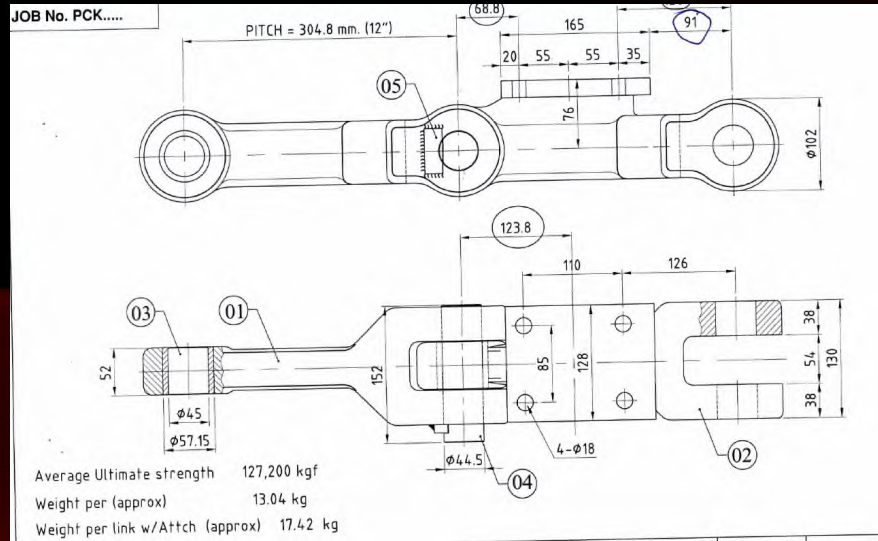



# Application of 304.8mm Chain

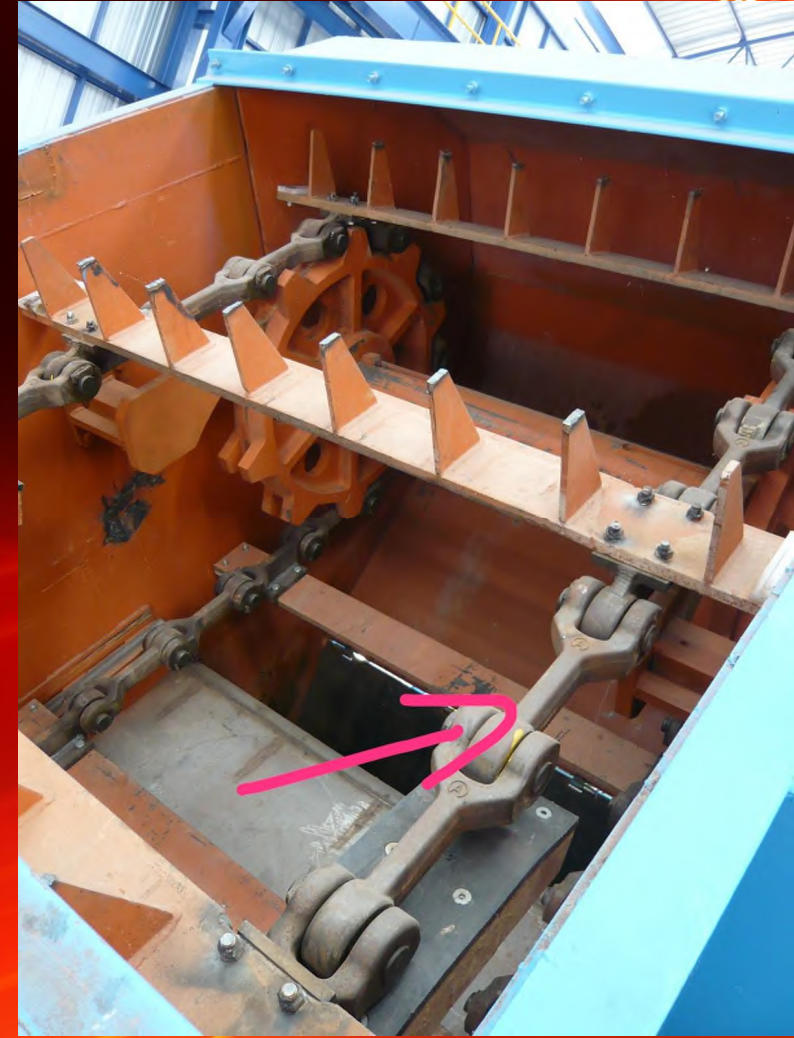



# Roller Chain for Conveyor





# Application of Roller Chain for Reclaimer





# Wear parts for Crusher

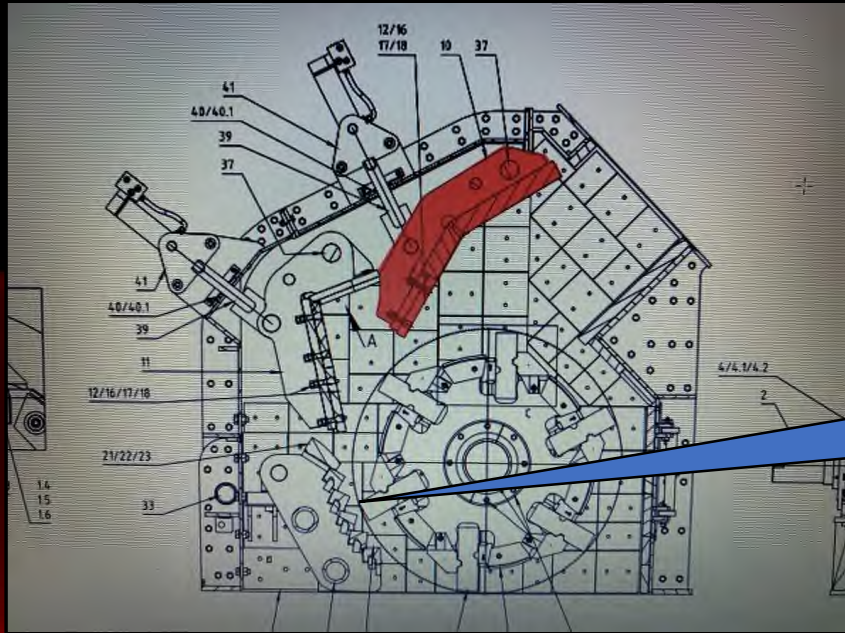

## \* POSITION :

- GRINDING PATH CLAMP PLATE
- GRINDING PATH BAR





# Grinding Path Bar

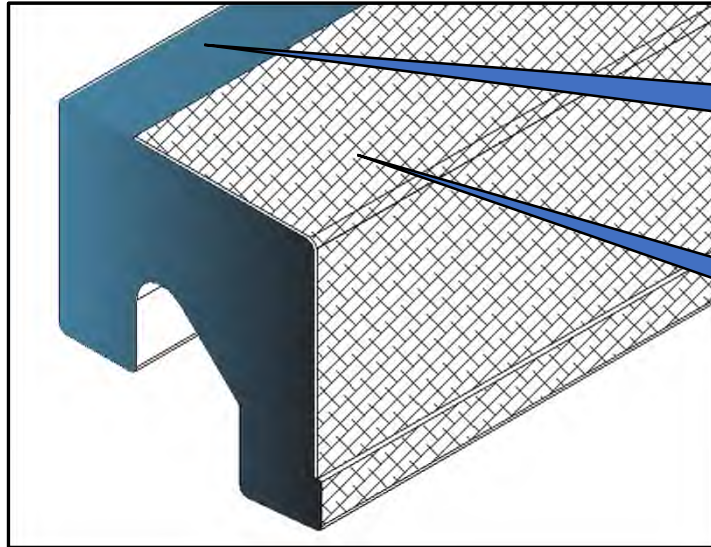

## CAST STEEL

➤ GX-120MnCr18-2

## PROFILE HARDFACING

➤ Complex Carbide





# Clamps





# On Site Service

