



WELCOME TO PILLAR HANDAL SEJATI

About Us



PT. Pillar Handal Sejati was established in 2010.

And we has specialized in sales and technical support of High Quality Valves & Pumps, Plate Heat Exchangers (PHE), and Plate & Gasket PHE parts.

Customer satisfaction is the key element of our company philosophy. Our entire team continuously endeavours to process your orders smoothly, reliably and on time. Thanks to the flexibility of our organization we can always offer you the best service possible.

Our Products

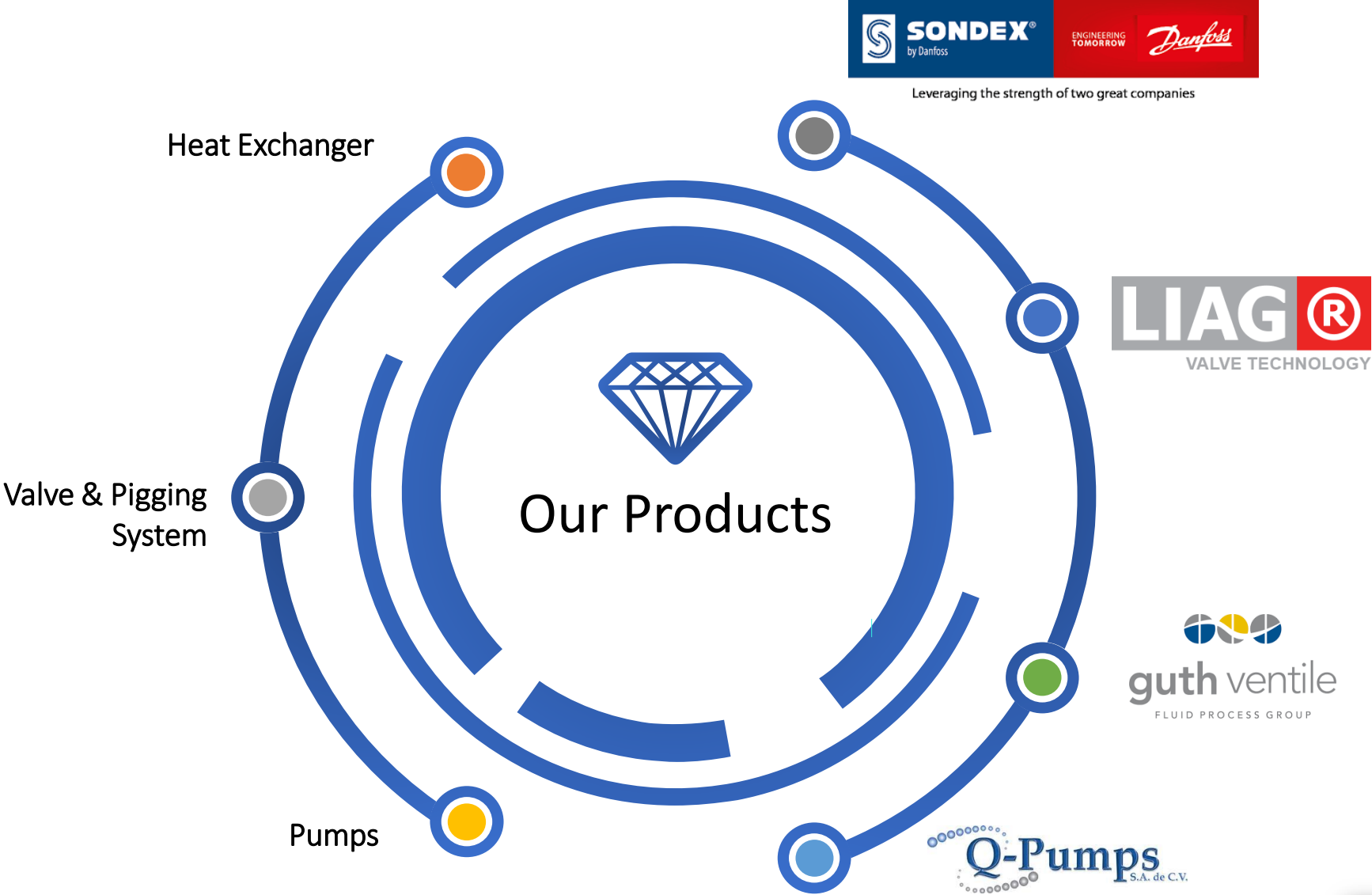



SONDEX®

by Danfoss

About Us

Sondex is a Danish company specialized in development, production of plate heat exchangers units and freshwater distillers.

Since the very start in 1984 Sondex has grown into one of the leading companies on the world market and has one of the most extensive ranges of plate heat exchangers known on the market today.

In 2016, Danfoss acquired full ownership of Sondex.

Industries We Serves

Palm Oil Ref



Refrigeration



Oil & Gas



Industrial



Power



Ethanol



SONDEX®
by Danfoss

ENGINEERING
TOMORROW

Danfoss

Leveraging the strength of two great companies

Marine



Pulp & Paper



Sugar



Food & Beverage



HVAC



Chemical

Brazed



Applications

- Heating and cooling of clean liquids
- Evaporators and condenser units
- District heating and ventilation
- Solar heating and air conditioning units
- Heating pumps and heat recovering units
- Temperatures from minus 180°C. up to 200°C
- Operating pressure can be as high as 35 bar.

Gasket PHE

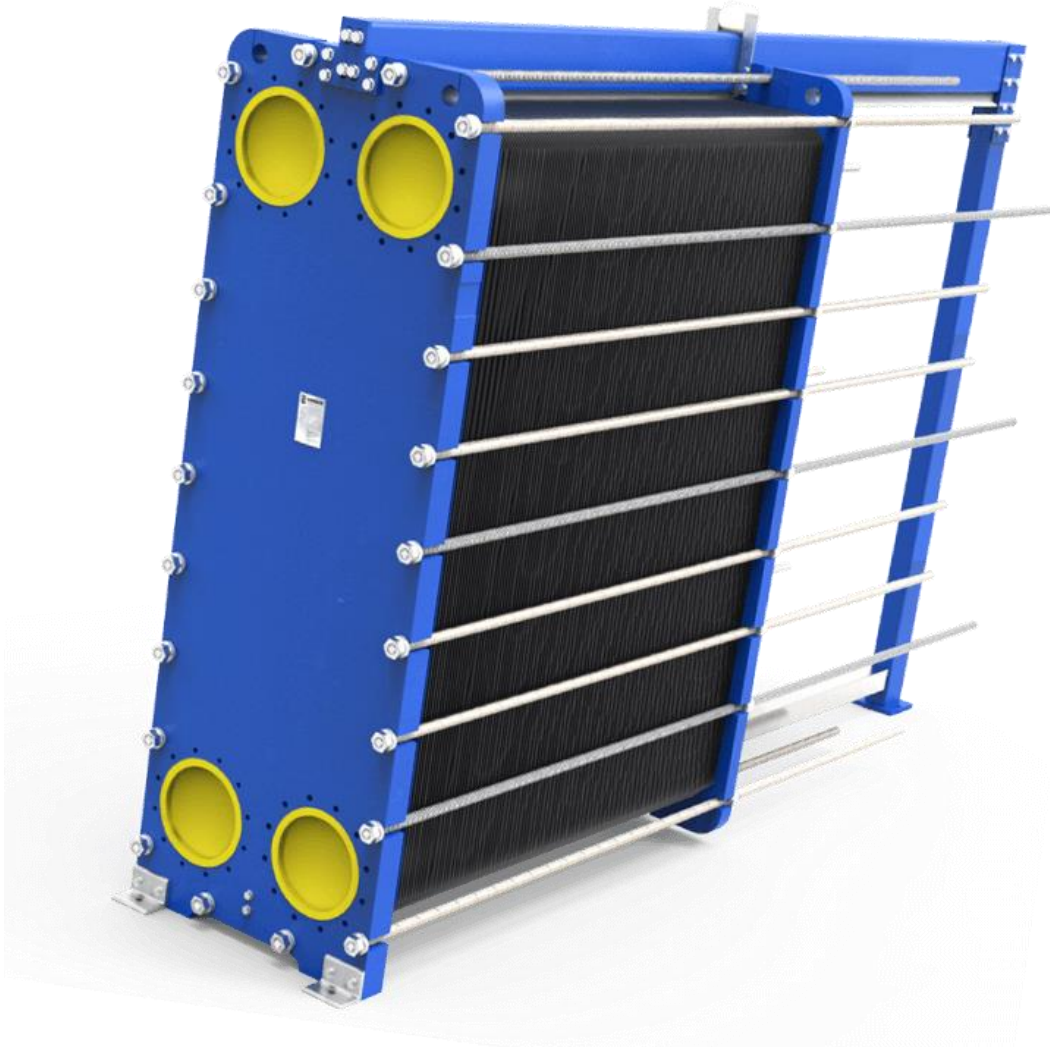

- Flow Rates : From 0.1 to 7,200 m³/hour
- Plate Materials : AISI 304 & 316, Titanium, SMO
- Gasket Materials : Nitrile, EPDM & Viton
- Pressure Rating : Up to 25 Bar
- Temperature Rating : Up to 180° C
- Connection sizes : 15 to 500mm

Evaporation

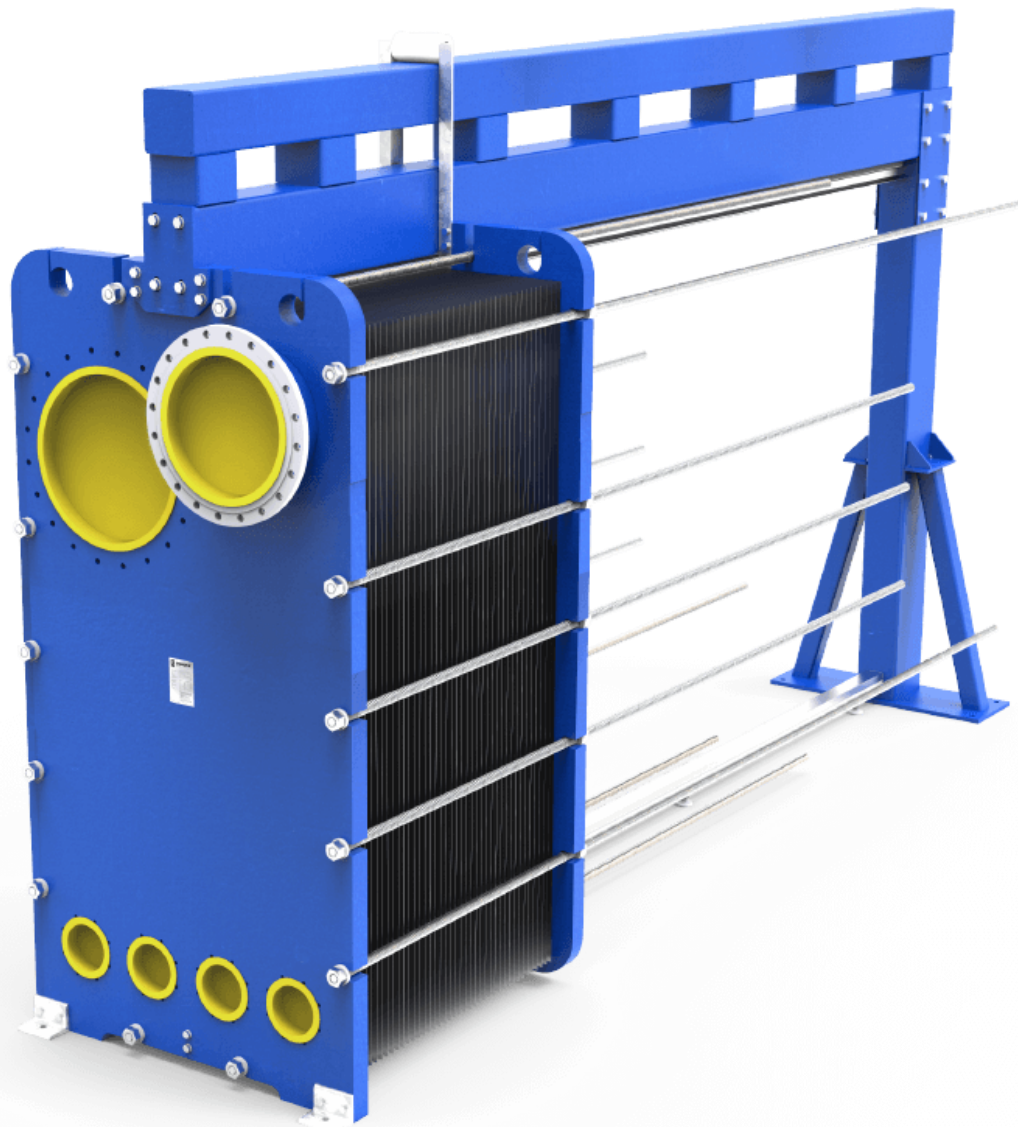

FEATURES AND BENEFITS

- ✓ Special plate design featuring an extra-large inlet connection for steam. Steam consumption can be reduced when operating with multi-stage evaporators, as the product vapor will serve as the heating media.
- ✓ Flexible design that makes it easy to increase capacity by adding additional cassettes or decrease it to save energy. Low residence time leads to perfect evaporation conditions and superior product quality.
- ✓ High performance, even with low temperature differences between the media, which is especially great for mechanical vapor recompression (MVR) and thermal vapor recompression (TVR).

Condenser

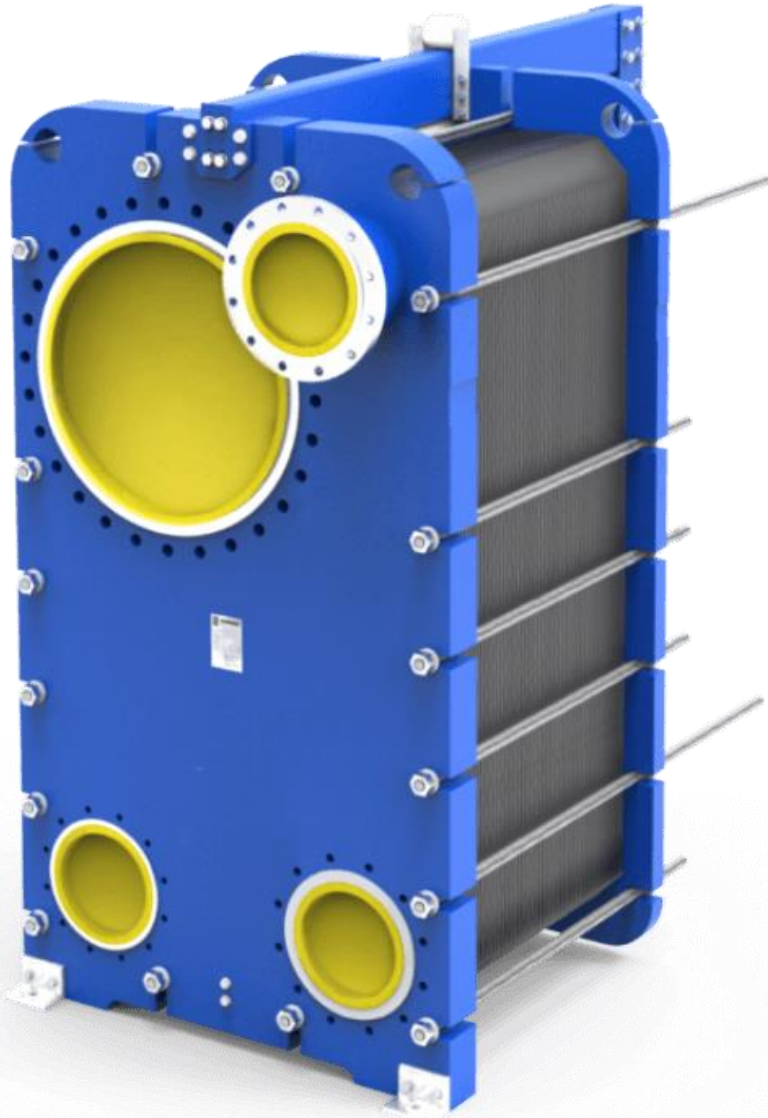

FEATURES AND BENEFITS

- ✓ Designed specifically for demanding condensation duties that benefit from a special asymmetric plate design that is unavailable for regular heat exchangers.
- ✓ Experience the high thermal efficiency of our SONDEX® heat exchangers and enjoy peace of mind with an ideal turbulent flow that reduces the risk of fouling.
- ✓ Special Multi-gap plate design that can lower the energy consumption considerably for condensation duties that differ in flow volume.

Semi Welded



FEATURES AND BENEFITS

- ✓ Very compact, cost-effective units that take up minimal floor space are light in weight, while providing very efficient heat transfer, through the courtesy of a true counter-current flow.
- ✓ The gasket-free solutions feature a fully welded plate pack that enable them to work with very high pressure and temperatures. The risks of leaks are severely diminished with a completely welded heat exchanger.
- ✓ The plates in the completely welded plate pack are made from highly resistant materials guaranteed to withstand even the most extreme working conditions.

Sondblock



FEATURES AND BENEFITS

- ✓ Perfect as condensers that can be configured to handle duties with or without condensate sub-cooling. SondBlock heat exchangers are also good choices as steam heaters or reboilers for non-cyclic duties, and a smooth and stable steam control system.
- ✓ A very durable heat exchanger that excels at handling aggressive and fouling media. Able to handle aggressive media on both sides, it is a perfect solution for crude oil refineries and petrochemical plants. A top choice for the most challenging duties.
- ✓ Increased production output due to the extended uptime of the heat exchanger. Very low maintenance and service requirements. Removable side panels provide fast and easy access to the plate pack for inspection or cleaning.

Shell & Plate



Applications

- Suitable for NH₃
- Evaporators and Condensers
- Fuel oil heaters
- Pressure rating: PN16/PN25/PN40
- From min. temp. -100°C to max temp.: Up to 400°C

Advantages

- Small space requirement (only 30% of a traditional tubular heat exchanger)
- No gaskets
- Safe operation without leaking
- High working pressure
- Small liquid volume
- Laser welded plates



Spiral

- Designed for demanding fluids of very high viscosity
- Possible to run Free Flow on one or both sides
- Designed with welded spacer studs to increase the turbulence and heat transmission
- Easy access to the heat transmission area
- Easy maintenance and cleaning without any use of special tools
- Very compact heat exchanger - saving valuable production area



LAEUFER International AG

Quality made in Germany





Arc & Pigging Valves



Hygienic Pigging Systems

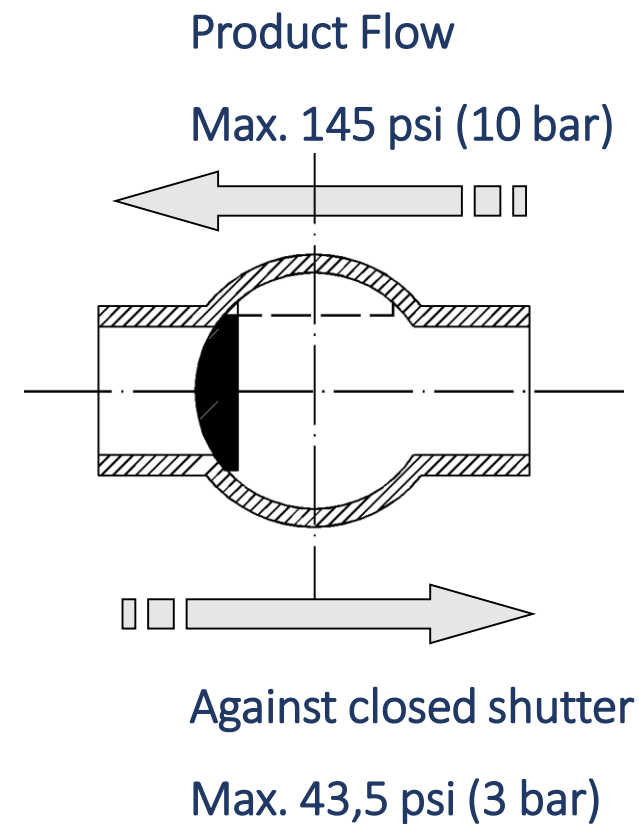
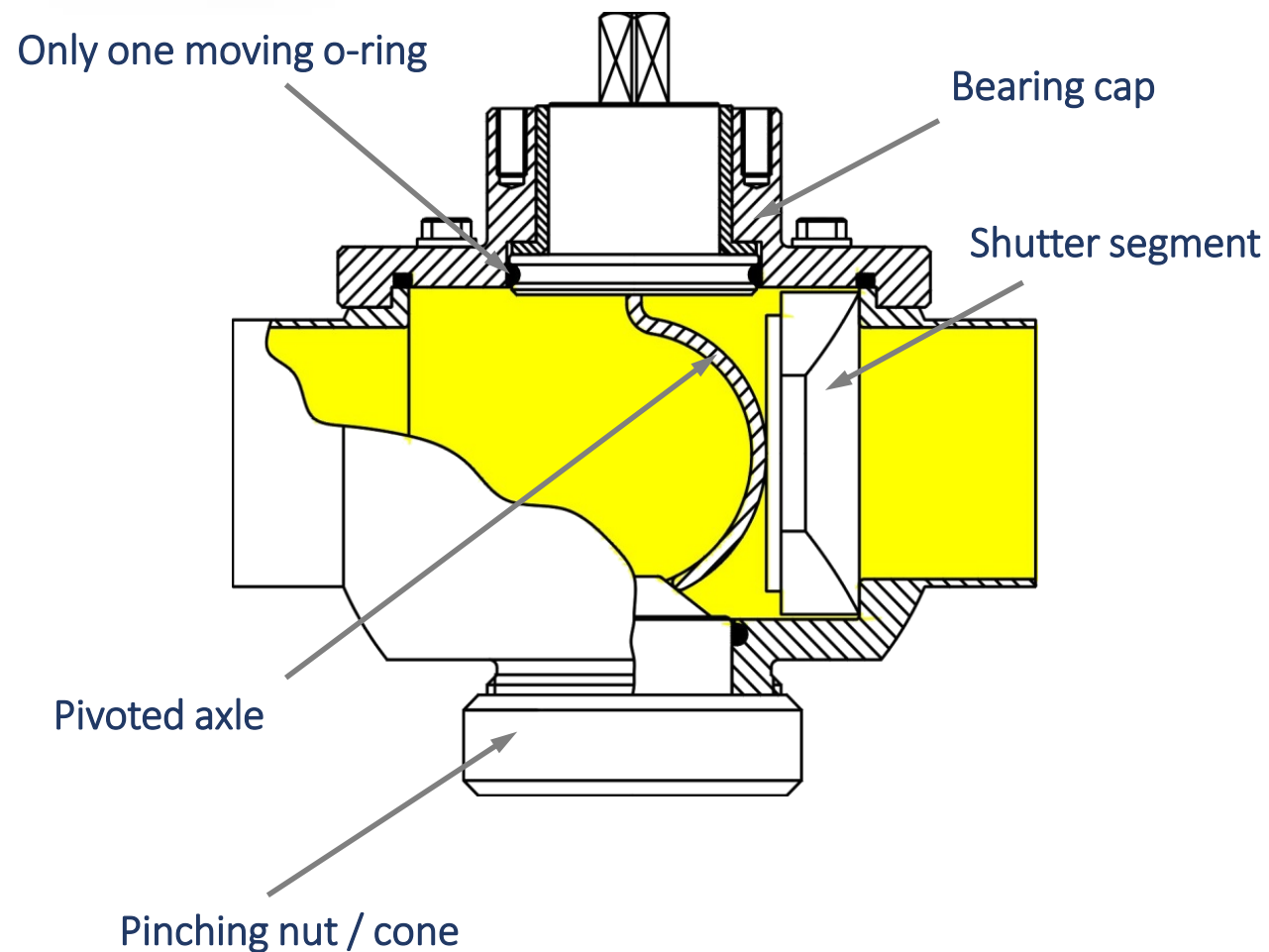

Clip “Valve Parts”

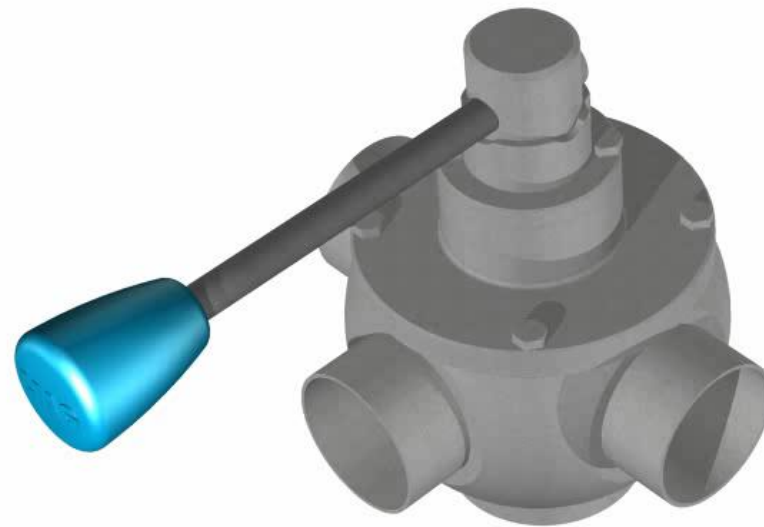

LIAG®

OPEN

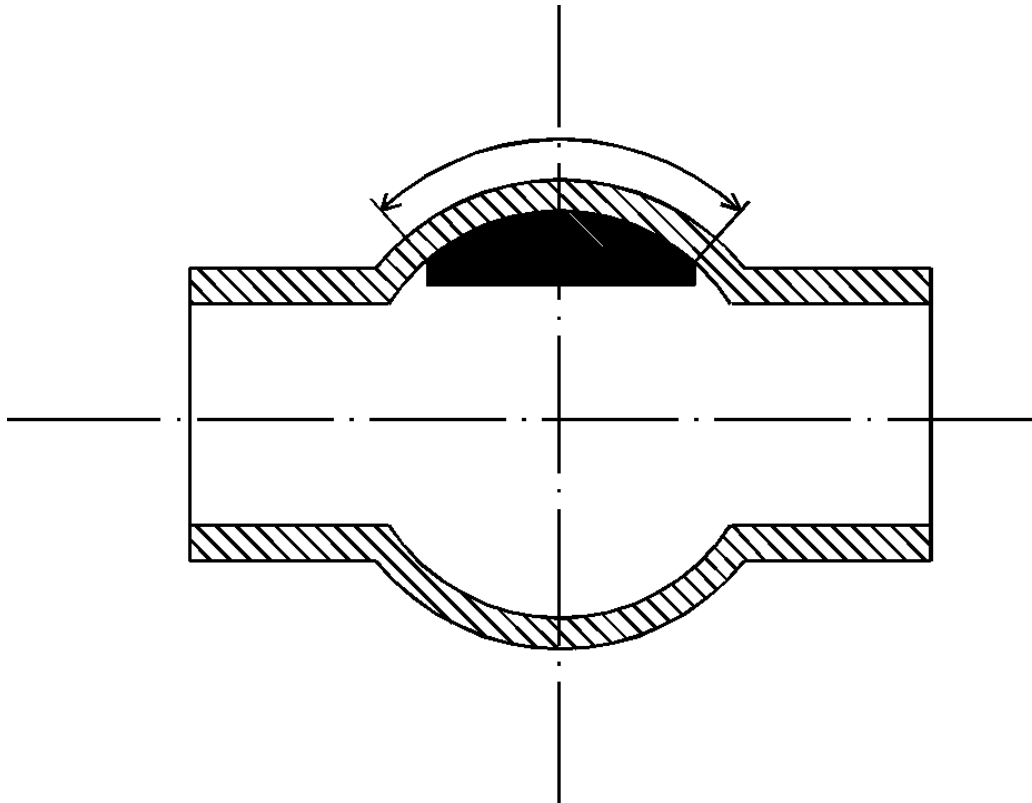

CLOSED

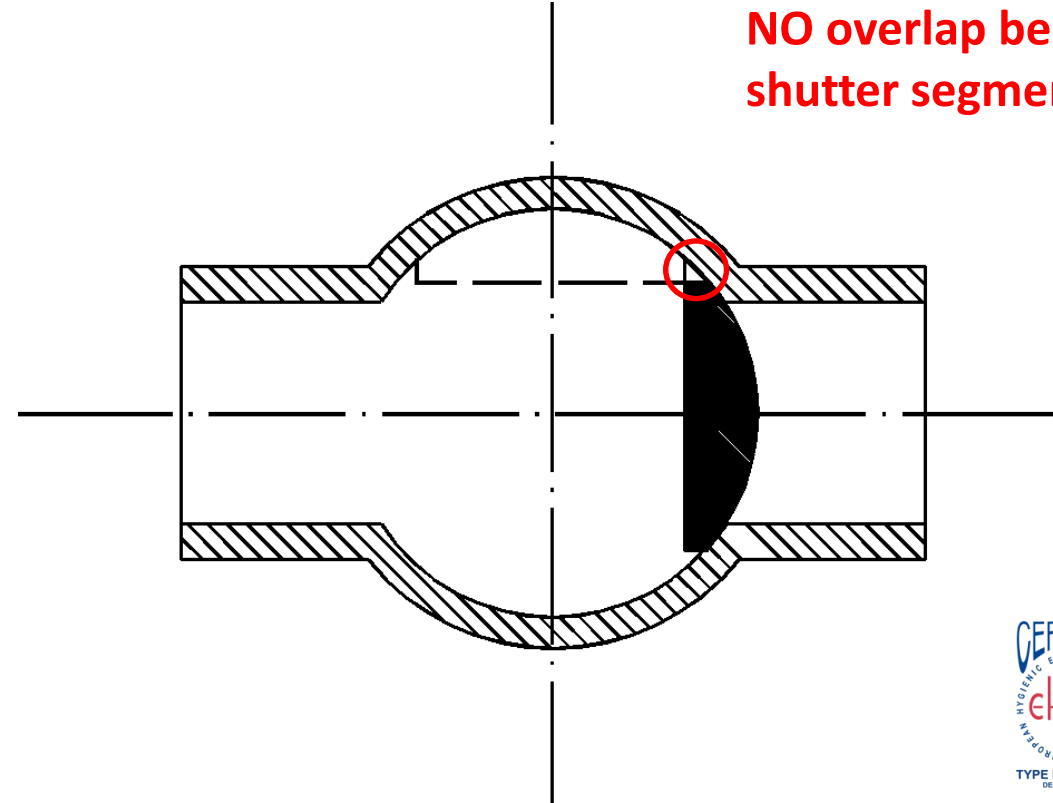

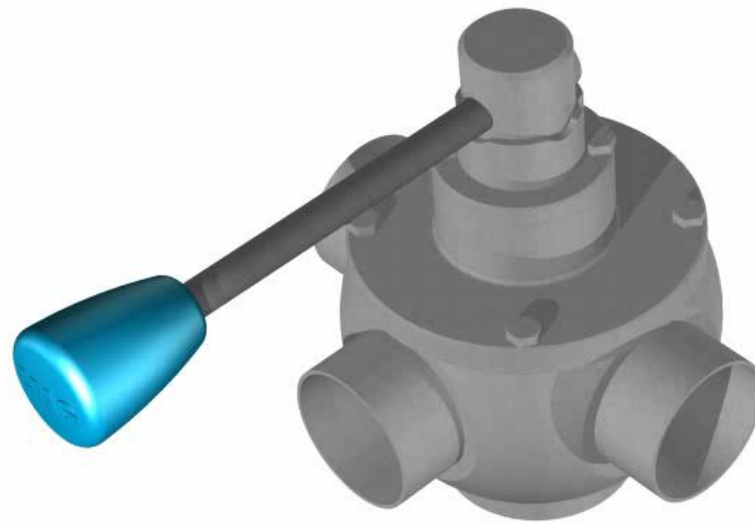

2-Way Arc Valve

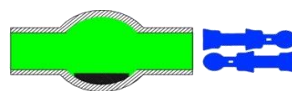

Shut off „Open/Closed“
0°-90° / 0°-180°

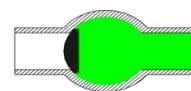

3-Way Arc Valve

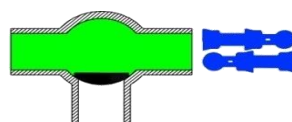
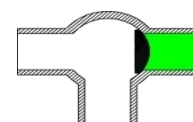

Distributing
0°-90° / 0°-180° / 0°- 90°-180°

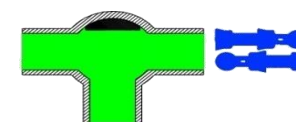
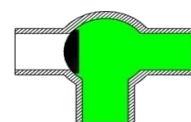

Option

4-Way Arc Valve

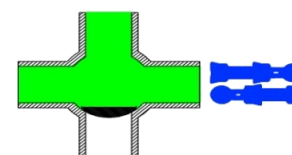
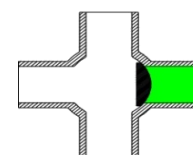

Distributing
0°-90° / 0°-180° / 0°- 90°-180° / 0°- 90°-180°-270°

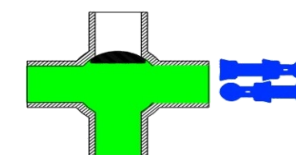
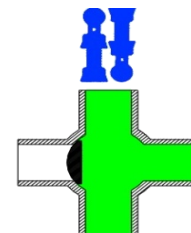

90°/120° Pigging Valve

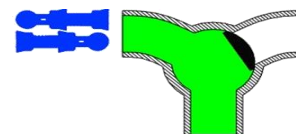
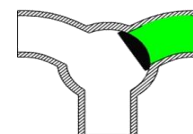

Soft distributing / Soft turn round of the pig
0°-120° / 0°-120°-240°

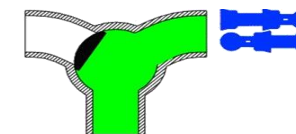
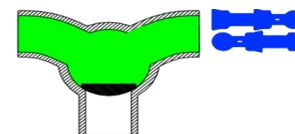

- **NO** dead pockets
- **NO** product remainders
- **NO** sticking of solid particles
- **TOTALLY** clear passage -> no pressure loss
- Designed for LIAG DMV 2-lip pigs
- Minimized number of single & wearing parts
- Can be dismantled even when welded in place
- Modular design
- **Optimally suited for high viscous, fast hardening media and/or solid particles inside**



A
3
51-01

CERTIFIED
HYDRA-ENGINEERING
el-edg
TYPE EL - CLASS I
DECEMBER 2011

- Sizes: 1"-6" (DN25-DN150)
- Executions: 2 & 3-way, manually or pneumatic actuated
- Connections: Welding ends / Tri-Clamp / Thread Connections DIN & SMS
- Stainless Steel Material: AISI 316L (1.4404)
- Shutter Material: Hostaflon (PTFE TFM 1600)
- O-ring seals: EPDM, FPM (Viton)
- Surfaces: Ra < 32µin (0,8µm)
- Operating temperature 230°F (110°C), short-term 284°F (140°C)
- Operating pressure in flow direction 145 psi (10 bar)
- **Various options available,
such as harder shutter materials to increase operating pressure and temperature**

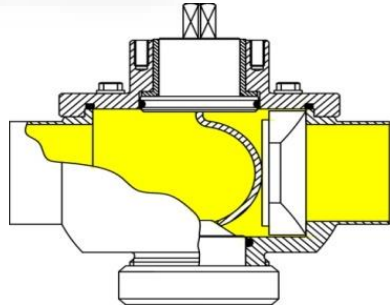

- NO dead pockets
- Free of blocking
- 0°- position without influence for pigging
- Easy to disassemble for maintenance even when welded in place
- Minimum no. of wearing parts
- Reliable tight also at low pressure
- Designed and approved for CIP/SIP

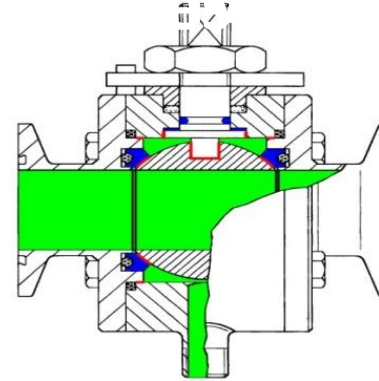

- Dead pocket
- Blocking possible
- 0°- position effects pigging
- Difficult assembling for maintenance
- High no. of wearing parts
- Leaking possible at low pressure
- Not really CIP/SIP capable

- Safe & quick separation of product – no mixed phases
- Minimized product loss
- Reduction of time-consuming cleaning and waste water
- Increase of product quality
- Environmentally sound



The combination of 3-A rated & EHEDG approved LIAG© ARC & Pigging valves

+ dynamic LIAG© lip pigs

**= LIAG© DMV Pigging System for low-germ processes
and highly viscous, fast hardening media**



DMV Lip Pig – hygienic design

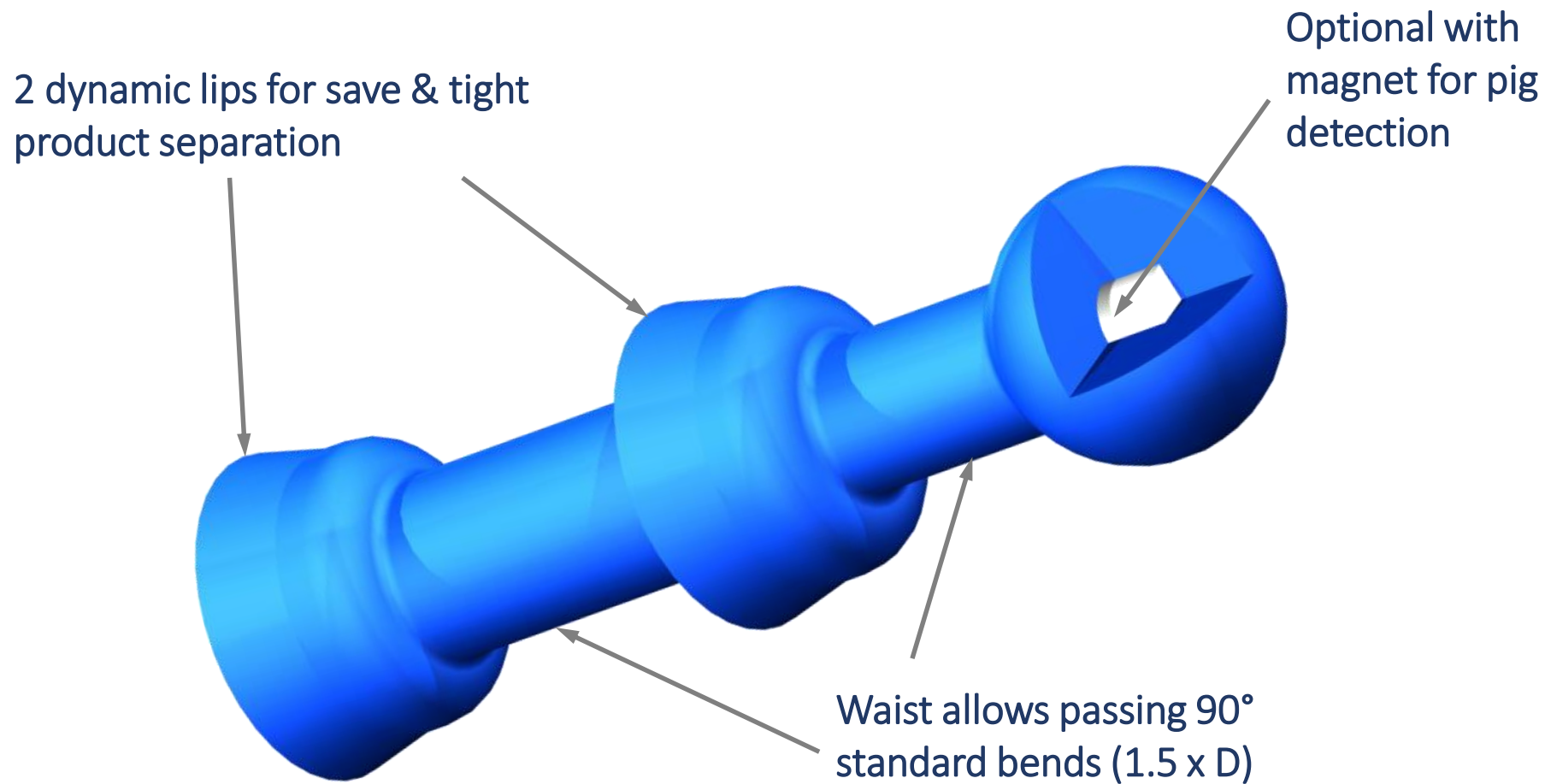

One-way system



Single loop system

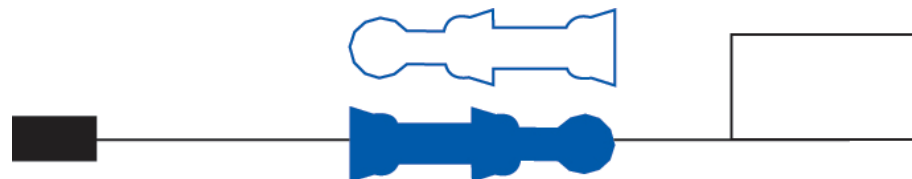

Double loop system



Ring system

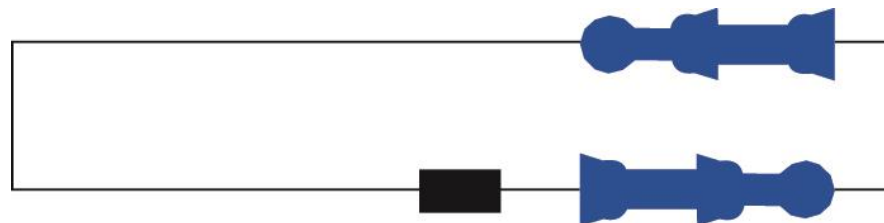

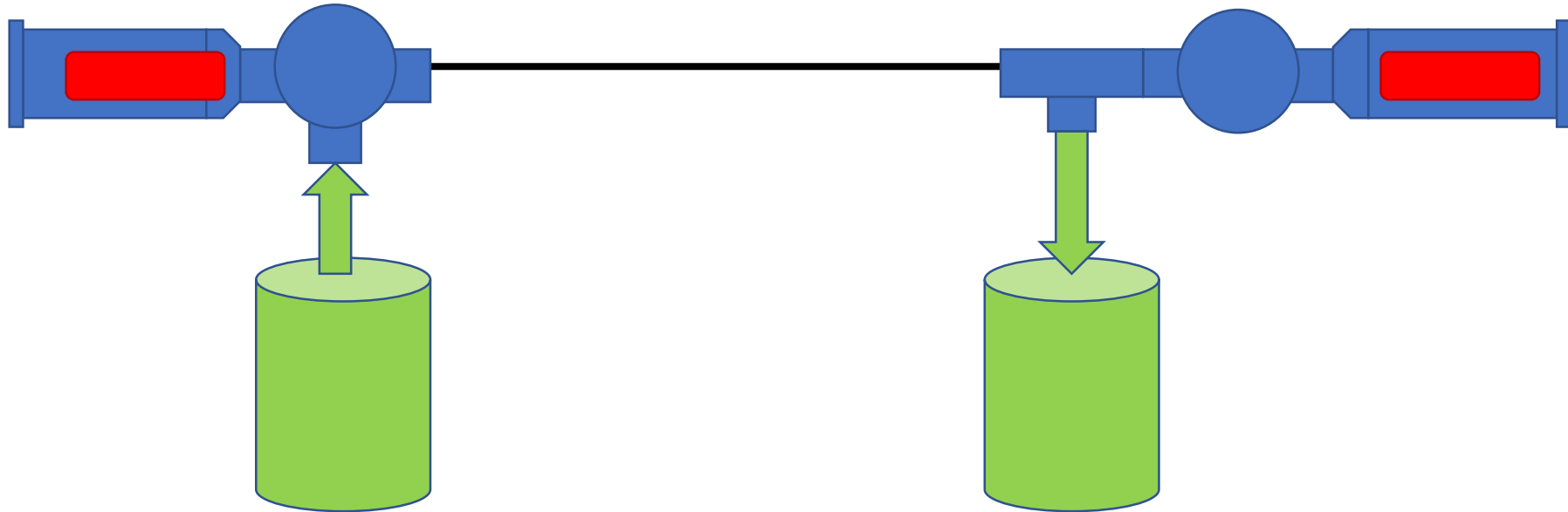

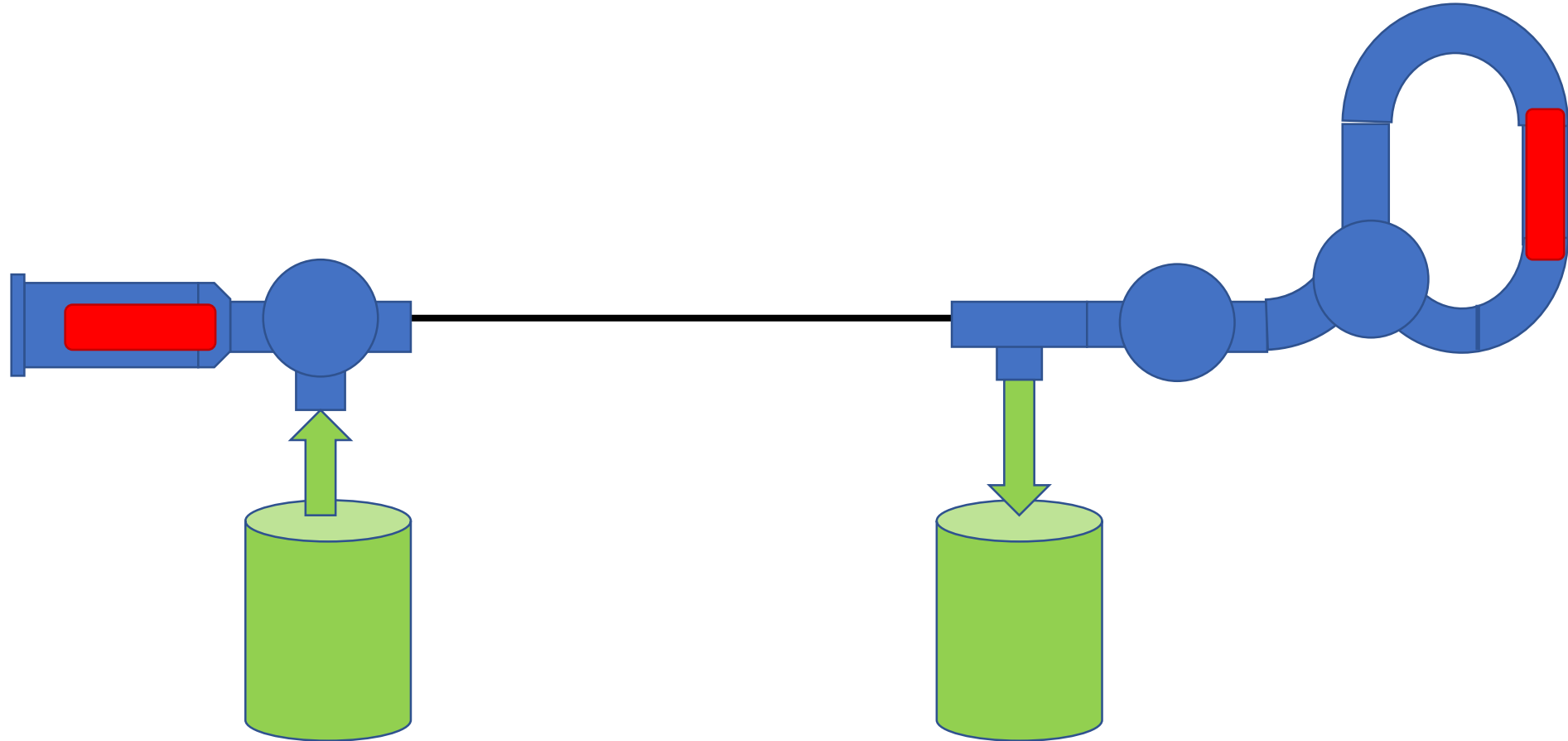

DMV Double Loop System

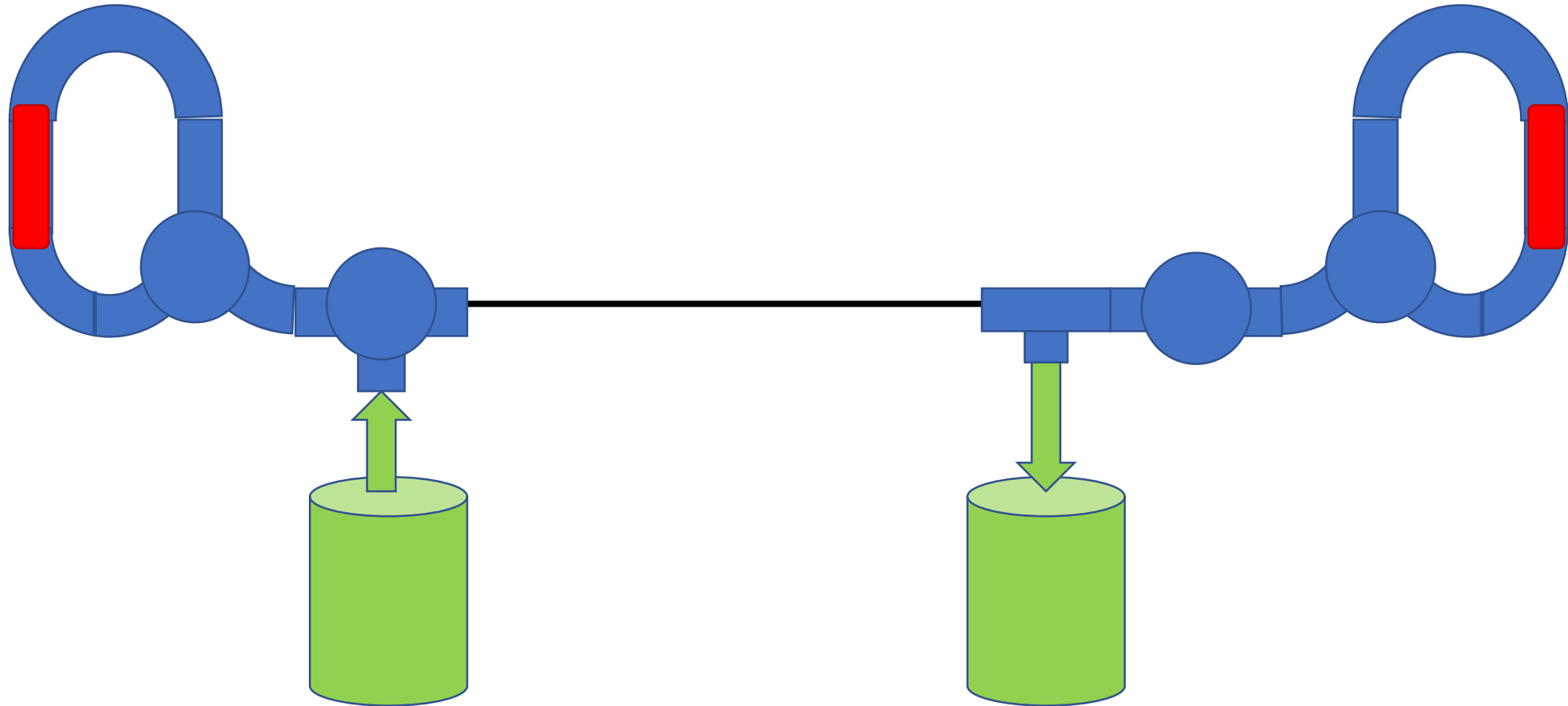

DMV Ring System

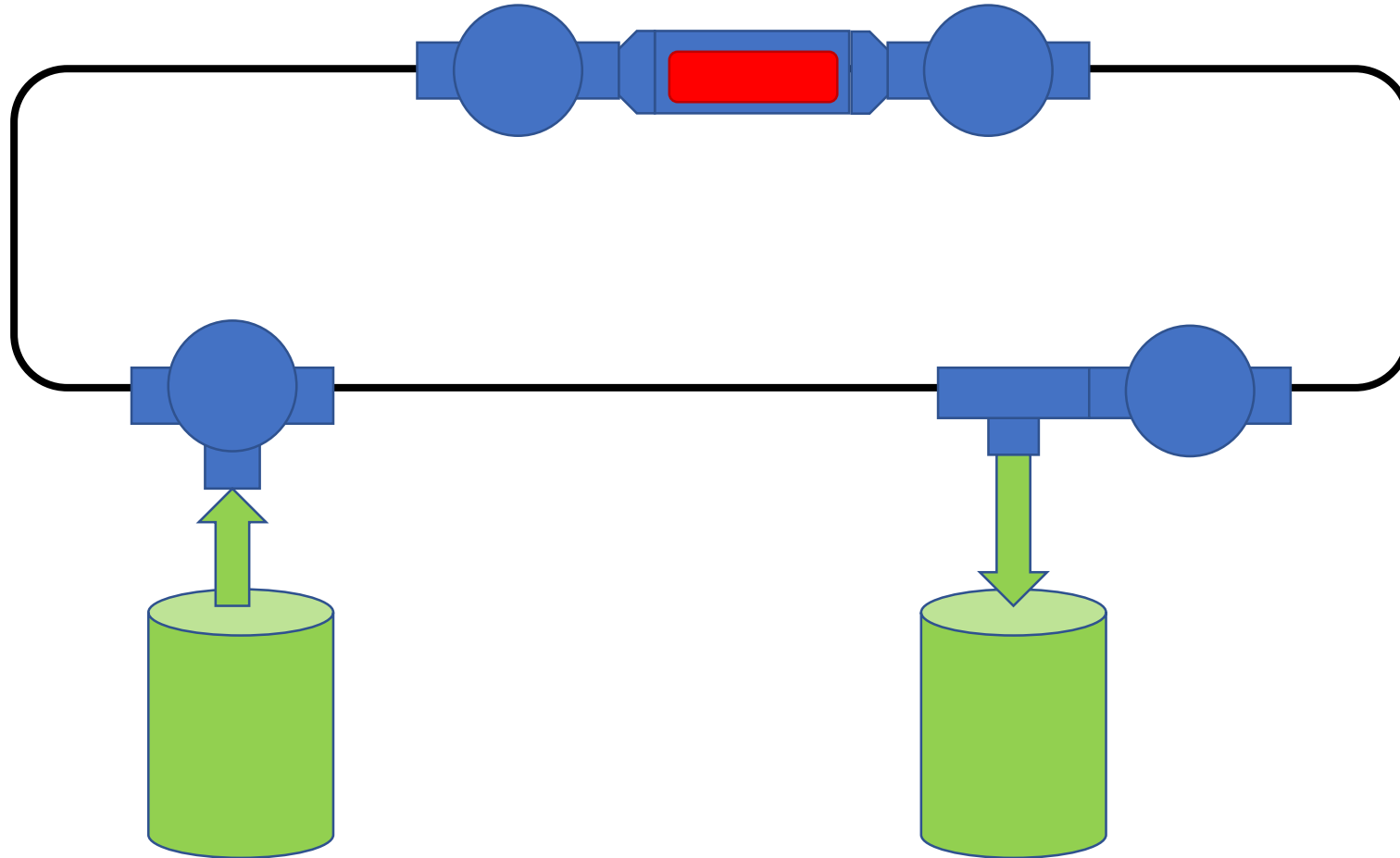

- Closed and sterile pipe system with CIP/SIP arc and pigging valves without dead pockets
- Optimized cleaning result by use of hygienic dynamic lip pigs
- Use of 90° standard bends ($R=1,5xD$)
- The pig can be cleaned in the closed system without removing
- Reliable & approved system with moderate R.O.I. (ask our references)

DMV pigging systems are optimally suited for low-germ processes and high viscous, fast hardening media, e.g. soft cheese, dressings, chocolate, concentrate, toothpaste, paints etc.

R.O.I Calculator

| | | |
|--|----------|------------|
| Select pipe dimension | 2" | |
| Volume per meter | 1.79 | [liter/m] |
| Enter total length of pipe in the line | 65 | [m] |
| Total volume in the line | 116.64 | [liter] |
| Enter product weight per volume | 1.25 | [kg/liter] |
| Total weight in the line | 145.80 | [kg] |
| Enter product price per kilogram | 1.50 | [value/kg] |
| Product savings each use | 218.70 | [value] |
| Enter waste treatment & disposal cost per kilogram | 0.20 | [value/kg] |
| Waste treatment cost savings | 29.16 | [value] |
| Total cost savings each use | 247.86 | [value] |
| Enter number of pigging operation per week | 5 | [] |
| Total savings after 1 year | 64445.31 | [value] |

About Us

- The owner-managed firm of Wilhelm Guth Ventiltechnik GmbH & Co. KG is a leading company in the field of development and manufacture of high-quality stainless steel control valves for the national and international markets. Our products are used mainly as process components in the sectors of beer and drinks, wine, dairy and foodstuffs and also pharmaceutical, biotechnology and cosmetics.
- Our highly-skilled and constantly trained employees manufacture valves and controls that are appreciated by our customers for their top quality, particular reliability and long life.
- We set the greatest store by the service-friendly structure of our valves in hygienic designs that permit maintenance without any special tools and thorough external cleaning. A comprehensive quality management system guarantees that all our manufactured products always meet the highest quality and hygiene standards.
- As an independent production company without its own plant construction function Wilhelm Guth Ventiltechnik GmbH & Co. KG is the ideal partner for end customers and plant contractors. Thanks in particular to the responsible and targeted collaboration within our team and with our customers, we stand out in a positive way in the market.



Butterfly Valves SV



Double Butterfly Valves DSV



Sandwich Double Butterfly Valves
SWDSV



Ball Valves KGH



Mini Seat Valves VSM



Seat Valves VS



Double Seal Valves VSD



Tank Bottom Drain Valves BAV



High Pressure Seat Valves VS-HD



High Pressure Double Seat Valves VSDS-
HD



Aseptic Seat Valve VS



Aseptic Modulating Valve VSR

Q-Pumps

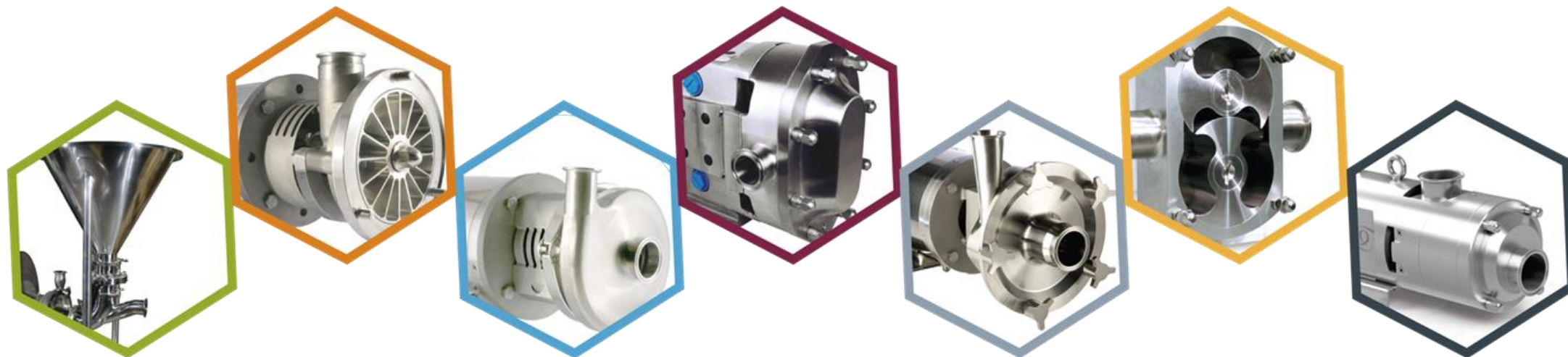

THE BEST SOLUTION FOR YOUR
SANITARY PROCESSES

ABOUT US



Since 1997, Q-Pumps has been dedicated to the manufacturing of sanitary pumps (centrifugal, positive displacement, self-priming and blenders) with the sole purpose of providing **the best solutions** for applications in the food, dairy, beverage, and pharmaceutical industries.



Our presence is in over 40 countries with the perfect combination between human capital and cutting-edge technology.



All of our products are certified and meet the highest standards, guaranteeing a 100% sanitary process.



ABOUT US



Technology is in constant evolution and so are we, our more than **20 years of experience** endorse us.



1997

2013

2018

Renowed Mexican technology

OUR SERIES



QTS SERIES



QCB+ SERIES



SP SERIES



ZP SERIES



QL SERIES



QC+ SERIES



SHEAR

QTS SERIES

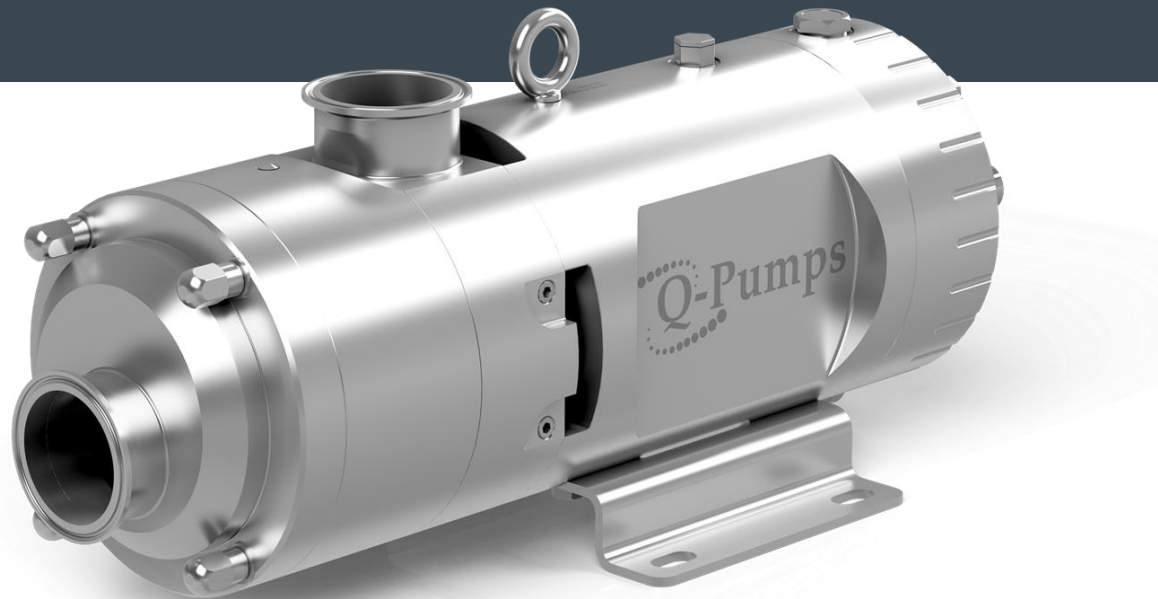

Mechanical Seals

- Single or double mechanical seal
- Easily converted from a single seal to a double seal
- All Models come double seal ready
- The QTS is capable of handling a vacuum of 28" of Hg

This pump consists of two intermeshing screws moving in opposite directions, whose axial movement causes a displacement of the product.



Twin screw pumps feature a continuous non-pulsating flow, directly proportional to the number of revolutions and they are well suited for the handling of suspended solids without damage such as dairy products, cosmetical, pharmaceutical F&B industry, fruits, vegetables, honey, dough, minced meat, pet food, caramel, marmalade, etc.

ADVANTAGES

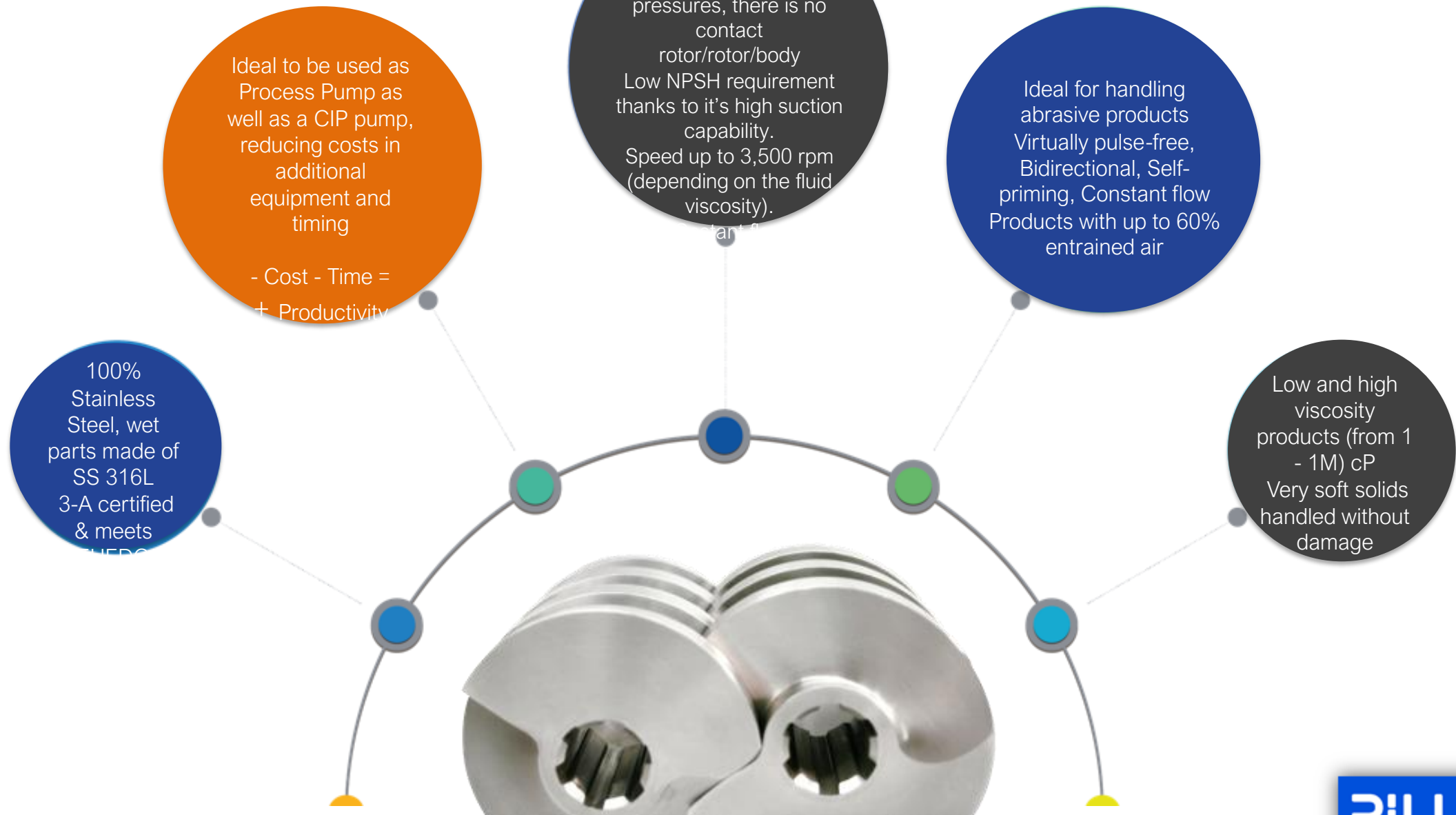

New technology Available now

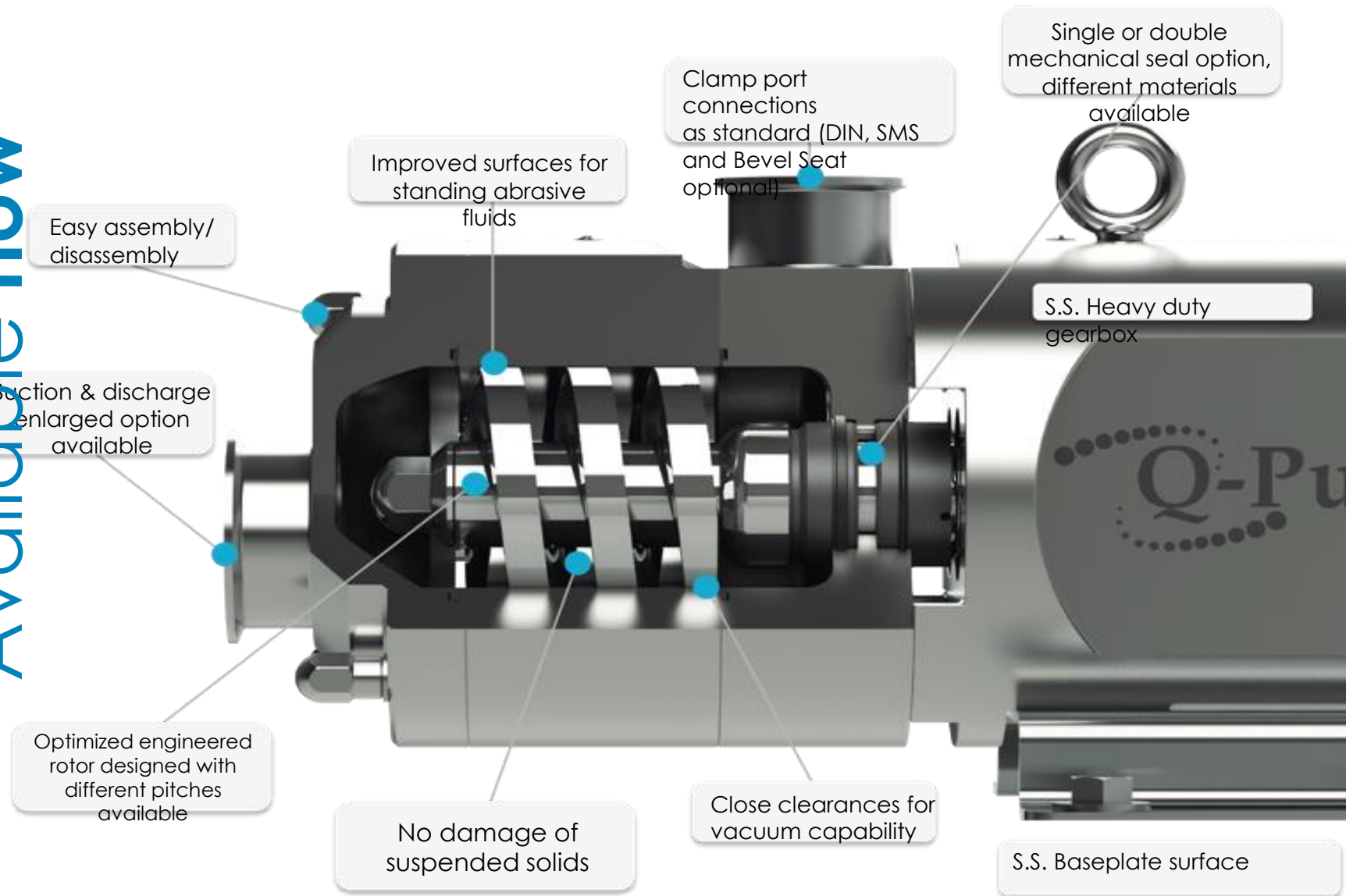

SP SERIES



It also handles fluids with entrained air without cavitation thanks to tight manufacturing tolerances, while the liquid ring created in the pump enables SP pumps to handle shear-sensitive products efficiently.

SP Series are 100% hydraulic and dimensionally interchangeable with other pumps in the market.



It is ideal for CIP applications and can handle viscosities up to 3,000 cps (thixotropic fluids) and temperatures up to 120°C.

ZP SERIES



It is designed to handle high pressures thanks to its versatility, with bi-wing and single-wing rotors available.

The ZP series are **UNIVERSALLY** interchangeable and compatible with other brands in the market.



Unlike other competitors, the pump is supplied with a stainless steel gearbox without impacting the price.

ADVANTAGES

- ZP3 Series has a front access seal, which makes it easier to maintain and 100% CIP
- ZP2 Series can be upgraded to ZP3.
- ZP3 pumps hold **3-A** and **EHEDG** certifications.
- High-torque shafts and helicoidal gears.
- Flexibility for four different mounting positions.
- Greasers threaded on both sides of the gear box.

QL SERIES



The models have capacities ranging from 0.020 to 3.34 L/rev (up to 441 GPM) and pressures of 8, 12 and 20 bar.

The QL Series are used mainly for moving products with high viscosities (from **500** to **1,000,000 cPs**).



Q-Pumps success relies on excellent performance in a wide variety of sanitary applications as well as the certainty of working with 100% CIP systems with low-cost equipment.

ADVANTAGES

- Holds **EHEDG** and **3A** certificates.
- Covers a wide range of applications at a competitive price
- 100% CIP
- Front-access seals for easy maintenance, quick cleaning and less time off. Just by removing the front cap, both rotors and seals are accesible without disconnecting the process line.
- The geometric design of the Bi-Wing rotor is interchangeable with Single-Wing, Tri or Multi-Lobe without making modifications. Besides standard rotors that handle up to 150°C, we have a high-temperature option (with higher tolerances).
- Standard mechanical seals are made from tungsten carbide, but other options are available for applications such as oils, greases, or chocolate.

QC+ SERIES



- Versatile and cheap, the QC pump is an open-impeller pump, radial flux and casing.
- It is ideal for products similar to water and liquids with viscosities of 600 cPs.
- It has different seal types for each application.

- It can move flows of 1200 GPM and loads of 270 ft.



ADVANTAGES

Q-Pumps is a worldwide leader in the production of centrifugal pumps, holding the **3-A** certificate.

- We have the QC, QC+ (plus) and industrial series IC+ (plus).
- Only manufacturers of 4410 and 6410 (QC, QC+ and IC+).
- QC+ **plus** series is Q-Pumps exclusively. The hydraulic performance and external dimensions are identical to QC's.
- Every part that makes contact with the product is built in stainless steel T316L, the rest is manufactured in steel T-304.

QCb+ SERIES

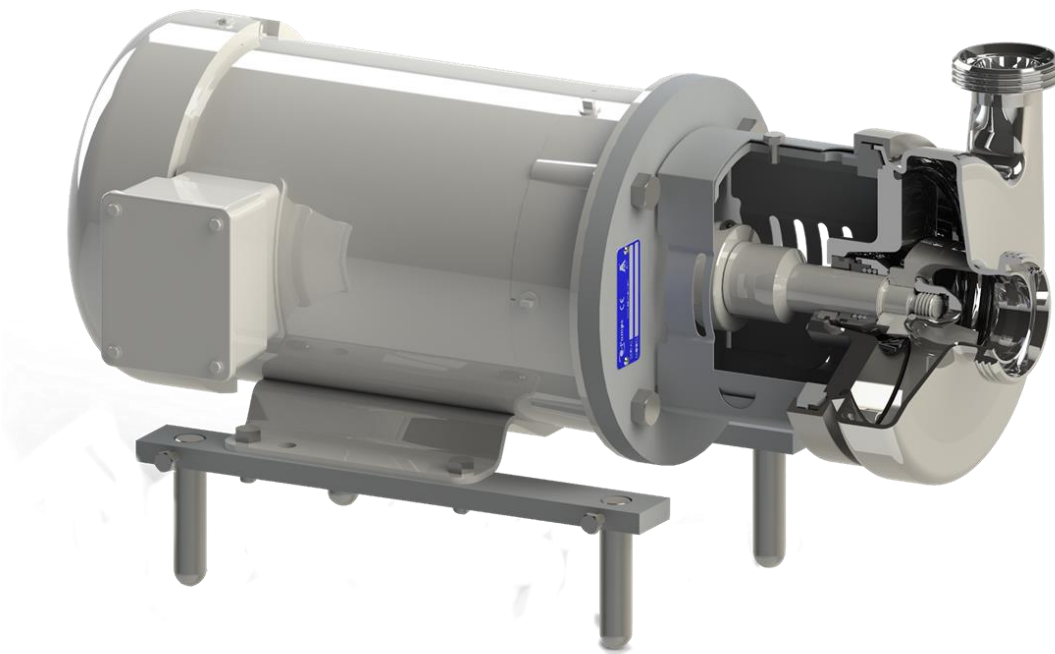

We have created the QCB+ Series especially for the beverage industry. Its improved technology and **3-A certificate** ensures the **best performance** in centrifugal pumps.

ADVANTAGES

- Holds **3A** certificate.
- Reduction of damage generated by water hammer, which extends the life of the seal and avoids the usual drips generated by wear.
- It represents a great saving since the QCB+ Series is hydraulically and dimensionally interchangeable with QC / C series pumps and can be converted into a QCB+
- The internal seal is submerged inside the product to promote cooling, which reduces cavitation and provides a constant flow.
- The pressure of the pump generates greater closing force on the faces of the seals, minimizing the agglomeration of the product.

ADVANTAGES

PUMPING VOLUTION

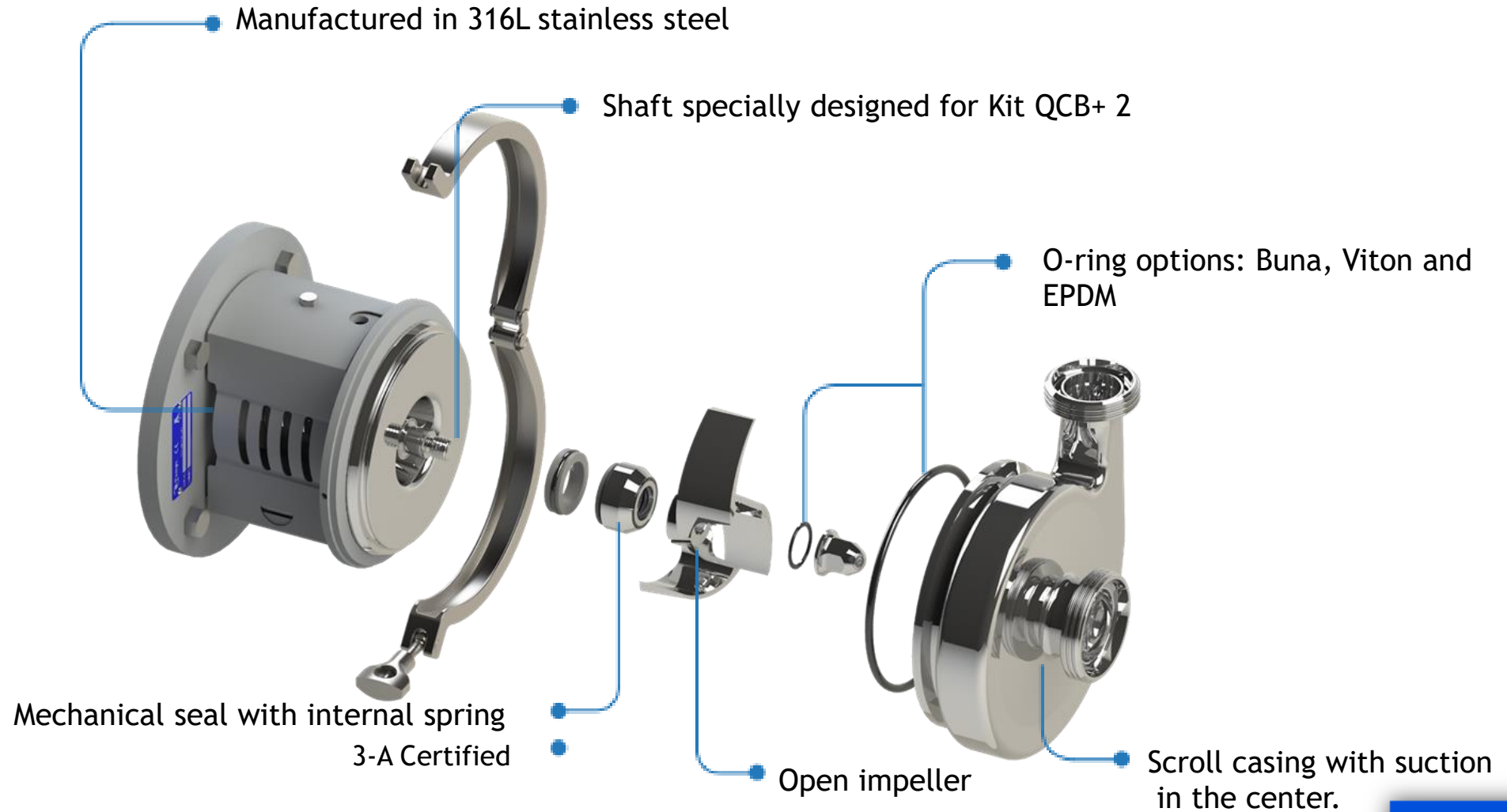

SHEAR BLENDER



- Virtually any application in which it is required to add quickly, efficiently and reliably any type of powder to a liquid mixture.
- Q-Pumps offers blending equipment for mixing powders with liquids, delivering an excellent performance due to its innovative design.
- The suction induces helps to reduce the NPSH requirement generating a suction vortex.
- Specially designed for homogenizing, blending, emulsifying, dispersing, dissolving and texturizing in a reduced processing time.

OUR PRODUCTS

Our pumps are manufactured within American (NEMA motors) and European norms (IEC B14/B5 motors), fulfilling the requirements of each and every market.

We are **3-A certified** in every product to guarantee hygiene in all the handled products.



PT. Pillar Handal Sejati



Main Office

Taman Tekno, blok H7/10, BSD City,
Jl. Tekno Raya, Setu, Kota Tangerang
Selatan, Banten 15314

Telp : 021-29666 277

Fax : 021-29666 280

Email : info@pillarhandal.com

Website : www.pillarhandal.com

PT. Pillar Handal Sejati

Warehouse



Citra Raya Bizlink Industrial Estate, block
R5/9, Tigaraksa, Tangerang 15720, Banten,
Indonesia

2nd Office & Warehouse

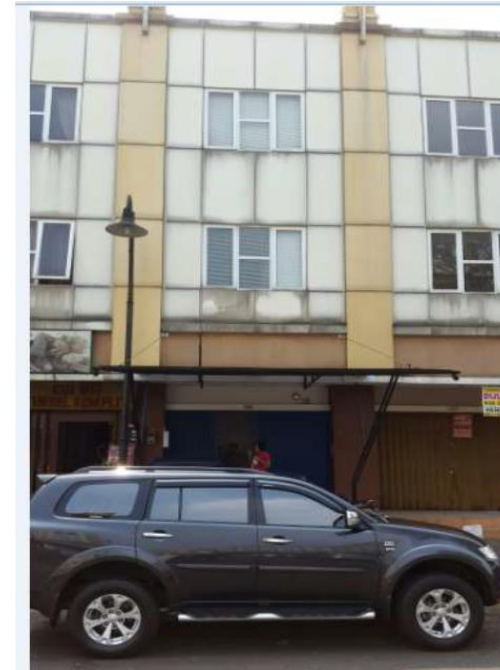

Ruko Golden Boulevard Blok S3
BSD City, Serpong, Tangerang, Banten,
Indonesia

SERVICING SOLUTION

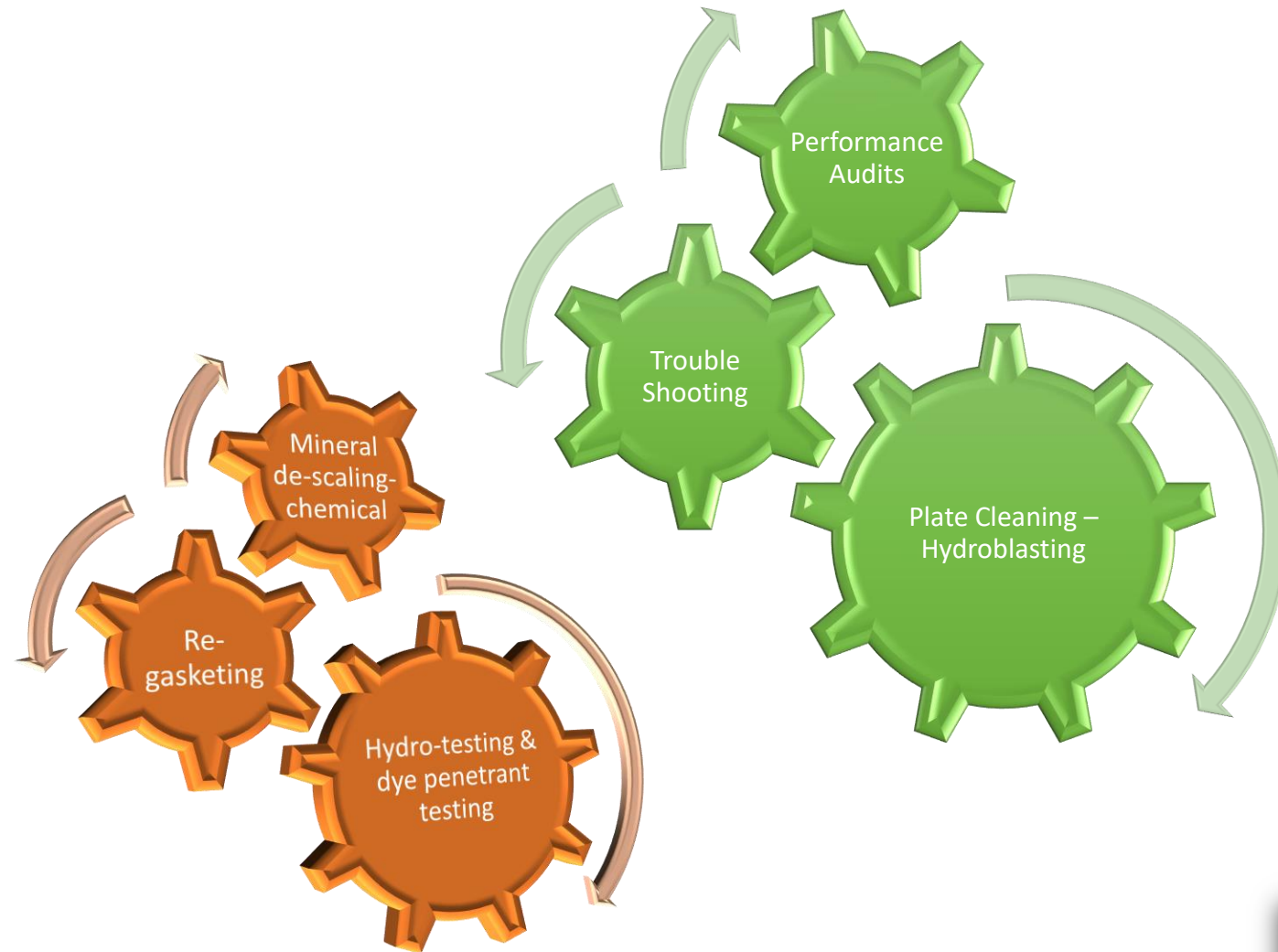

OUR CLIENTS



 @pillarhandal

 @pillarhandal

Get in Touch

put your great subtitle here



Taman Tekno Blok H7 / No. 10
BSD City – Tangerang - Indonesia



ask@pillarhandal.id



+62 21 – 29666 277



THANK YOU

See you soon